



# LGH

AUSTRALIA 1<sup>ST</sup> EDITION

TECHNICAL USER GUIDE

# Lifting Equipment Rental Specialists



HOISTING



RIGGING



PULLING



MATERIAL HANDLING



JACKING



SAFETY



# CONTENTS

## 03 About LGH

- 03 About LGH
- 04 Equipment & the Industries We Serve
- 06 Locations - Around the World
- 08 Locations - Europe
- 10 Our Trusted Partners

## 13 Hoisting

- 14 Hand Chain Hoists
- 15 Lever Hoists
- 16 Beam Clamps
- 18 Adjustable Beam Trolleys
- 19 Electric Chain Hoists
- 22 Accessories & Controls
- 23 Air Chain Hoists
- 24 Aluminium Gantries

## 27 Pulling

- 28 Electric Winches
- 29 Tirfor Machines, Ropes & Accessories
- 30 Load Equalising Dollies
- 31 Rotational Load Skates

## 33 Jacking

- 34 Jacks
- 35 Hydraulic Cylinders
- 40 Skidding Systems
- 41 Electric Hydraulic Power Units
- 42 Hydraulic Pumps
- 43 Hydraulic Accessories

## 45 Rigging

- 46 Modulift Spreader Beams
- 53 Modulift Spreader Frames
- 54 Multi-Lug Lifting Beam
- 55 Bow Shackles
- 58 Digital Load Indicators
- 59 Polyester Round Slings
- 60 Woven Wire Rope Slings
- 61 Flat Woven Wire Rope Slings
- 62 Equalising Triangles
- 63 Sheave Blocks

## 65 Material Handling

- 66 Material Lifts & Accessories
- 67 Material Lifts
- 68 Gas Hoists & Crane Bins
- 69 Goods Cages

## 71 Safety

- 72 Rescue Cages
- 73 Man Baskets
- 74 Confined Space Equipment
- 75 Fall Arrest Harness

# The experts in **LIFTING GEAR HIRE**

With over 50 years of experience, LGH is the single largest organisation devoted exclusively to the hire of lifting and moving equipment. With a commitment to safety and service, we operate in over 30 locations across North America, Europe and Australia, employing over 400 people.

At LGH, we put  
**safety first**



## **Family** is at the heart of everything we do

As a family-owned company for over half a century, lifting is in our blood. We've made a name for ourselves by combining the highest quality equipment with unrivalled expertise and impeccable safety standards.



# Equipment to **MEET EVERY** lifting or moving need...



## Hoisting

Complete your project safely and productively with the finest tools available from industry leading manufacturers.



## Rigging

Rig up a safe and successful operation with the right lifting beams, shackles and more from some of the best manufacturers in the industry.



## Pulling

Access the very best pulling and winching gear from leading companies and benefit from our expert advice.



## Material Handling

From Genie Material Lifts and roustabouts to pallet trucks and skoots, we carry a comprehensive range from market leading brands.



## Jacking

Our dependable range offers only the safest jacking equipment to lift and lower your load reliably.



## Safety

Our safety range extends from traditional safety harnesses and fall arrest blocks through to a range of confined access equipment.



## Industries we **proudly serve**

Whatever your industry, if you have lifting requirements we have the best quality equipment and years of expertise to deliver exactly what you need. We will support you throughout your project for a safe and successful lift every time.



Construction  
& Maintenance



Energy & Utilities



Petrochemical  
& Pharmaceutical



Marine



Transport



Offshore



Water



Waste



# LIFTING GEAR HIRE

around the world



## LGH North America

We're proud to serve the entirety of North America, offering the same high LGH standard of equipment across every single location.

LGH North America is now the single largest organisation devoted exclusively to the rental and sale of lifting and moving equipment, with over twenty warehouses across North America.



## LGH Australia

We're excited that LGH now has a presence in Sydney, Australia, with more locations on the horizon.

From small beginnings to delivering industry-leading equipment and advice across three continents, LGH continue to go from strength to strength.

# LGH LOCATIONS

## LGH Europe

LGH has experienced significant growth since its 2016 UK relaunch, establishing a presence in five key locations: Aberdeen, Glasgow, Manchester, Derby and London.

LGH's European footprint continues to expand, with four locations across Germany, the Netherlands, and Belgium.

Our operation ensures optimal efficiency and provides our customers with the very best service. All our European locations offer a comprehensive suite of top-tier core equipment.

Customer Contact Centre:  
1800 407 712 | [enquiries@lgh.au](mailto:enquiries@lgh.au)



### Mainland Europe Locations:

#### Germany

**Essen**  
Hafenstraße 280,  
45356 Essen

#### Hamburg

Bredowstraße 10,  
22113 Hamburg

#### The Netherlands

**Ridderkerk**  
Mandenmakerstraat 22,  
2984 AS Ridderkerk

#### Belgium

**Antwerp**  
Merantistraat 2C,  
2030 Antwerpen

# OUR TRUSTED PARTNERS

We only work with the best

Our commitment to safety and reliability drives us to partner with only the most innovative, market-leading manufacturers. If a supplier meets our high standards, it's a sure sign that you're going to be working with nothing but the very best.

**DURAPAC**

**LODESTAR**

**Modulift**  
by pewag

**J-D-NEUHAUS**  
engineered for offshore

**Delphi**  
MEASUREMENT

**SpanSet**

**ANDROMEDA**  
INDUSTRIES

**JUUKO**

**Tiger**

**JUNG**

**HILMAN**

**REID**  
LIFTING

**GP**  
Green Pin

**LIFTKET**  
WORKS 1948

**HYDRA-SLIDE**

**COMEUP**  
WINCH

**Tractel**

**Maxirig**

**YOKE**

**RUD**

**Genie**  
Authorized Distributor  
Sales · Parts · Service

**TITAN**  
MANUFACTURING

**pewag**

## Disclaimer

All equipment in this technical user guide is subject to availability and circumstances may lead to alternative equipment being offered.

The information in this technical user guide relating to the equipment has been provided by the manufacturers. Whilst the technical user guide has been prepared in good faith, no representation, warranty, assurance or undertaking (express or implied) is or will be made, and no responsibility or liability is or will be accepted by LGH or by its officers, employees or agents in relation to the accuracy or completeness of this technical user guide. All and any such responsibility and liability is expressly disclaimed. It is your responsibility to ensure that the equipment has the correct dimensions and weight to perform the tasks you require it for.

LGH reserves the right, without prior notice, at any time and in any respect, to alter any of the information contained within this technical user guide. No information set out or referred to in this technical user guide shall form the basis of any contract. Any prospective hirer of LGH equipment shall be required to enter into a legally binding agreement acknowledging that it has not relied on, or been induced to enter into such an agreement by, any representation, warranty, assurance or undertaking save as expressly set out in that agreement.



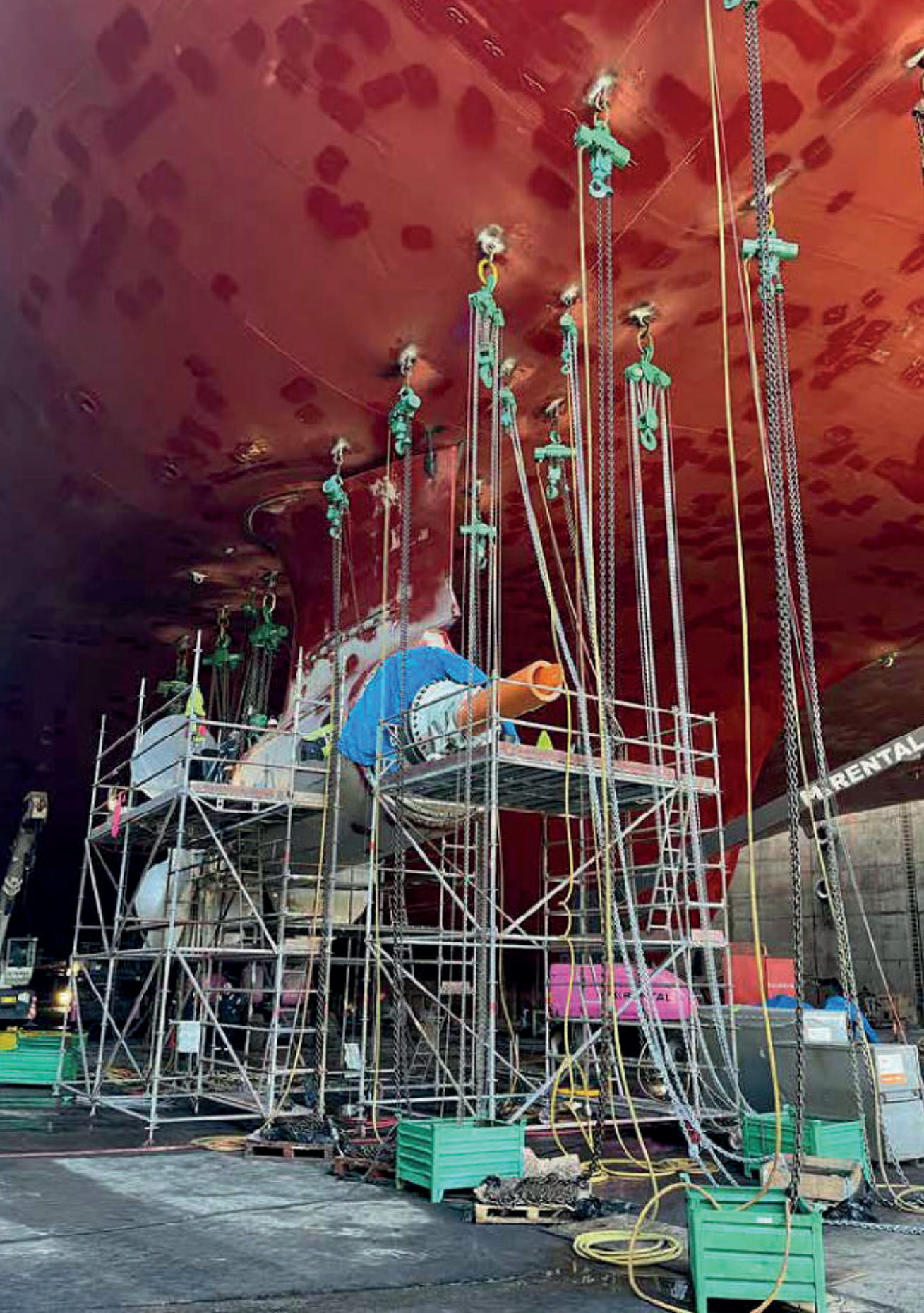

# 13

## HOISTING

- 14 Hand Chain Hoists
- 15 Lever Hoists
- 16 Beam Clamps
- 18 Adjustable Beam Trolleys
- 19 Electric Chain Hoists
- 22 Accessories & Controls
- 23 Air Chain Hoists
- 24 Aluminium Gantries



Unrivalled Lifting  
Precision



## Hand Chain Hoists

### PROCB Chain Hoists

- Range from 0.5t to 30t
- Rugged construction yet lightweight and portable
- Patented Quad Cam mechanical brake
- Operating temperature of -40°C to +80°C
- Proof tested to 1.5 times rated capacity
- Standard lift height 3m, 6m, 9m, 12m HOL and greater to meet your specific requirements
- Tested and certified for “fleeting” and “cross-hauling” application

Model	Capacity (Tonnes)	Effort (kg)	Dimensions (mm)								Load Chain		Std HOL (m)	Weight at Std HOL (kg)	Weight for Extra Metre HOL (kg)
			A	B	C	D	E	F1	F2	Diameter (mm)	No. of Falls				
PROCB-0100	1.0	25	93	66	340	63	87	28	45	6.3	1	3	11.5	1.9	
PROCB-0200	2.0	34	101	79	420	87	113	35	53	8.0	1	3	20.0	2.4	
PROCB-0300	3.0	38	109	84	500	98	157	36	56	10.0	1	3	30.5	3.2	
PROCB-0500	5.0	37	101	79	575	122	209	49	70	8.0	3	3	37.5	5.2	
PROCB-1000	10.0	40	109	84	660	153	263	54	87	10.0	3	3	64.0	7.5	
PROCB-1500	15.0	41	109	84	840	225	378	59	81	10.0	5	3	128.5	11.8	
PROCB-2000	20.0	43	161	90	1050	148	360	81	110	10.0	6	3	178.5	14.2	
PROCB-3000	30.0	42	220	220	1200	390	390	91	135	10.0	10	3	307.0	23.8	

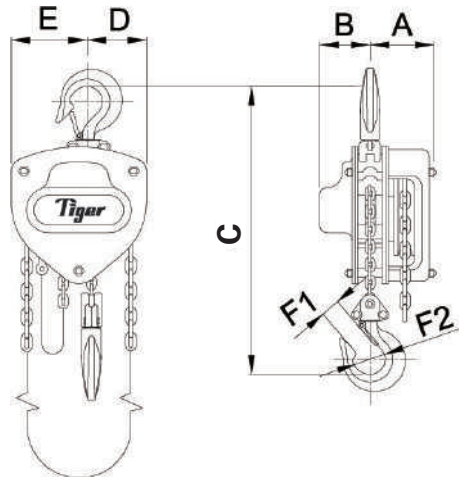

## Lever Hoists

### PROLH Lever Hoists

- Range from 0.8t to 10t
- Patented Quad Cam Pawl System
- Tiger’s unique dual brake mechanism
- One piece construction pinion gear
- Adaptable to use both inverted and horizontally
- 8 point multi start thread pinion shaft - increased efficiency in brake reaction times
- “EZ Check” hook feature

Model	Capacity (Tonnes)	Effort (kg)	Dimensions (mm)								Load Chain		Std HOL (m)	Weight at Std HOL (kg)	Weight for Extra Metre HOL (kg)
			A	B	C	D	E	F1	F2	Diameter (mm)	No. of Falls				
PROLH-0080	0.8	23	128	240	295	158	99	28	45	6.3	1	3.0	7.5	0.9	
PROLH-0160	1.6	28	154	360	320	172	104	34	51	7.1	1	3.0	10.5	1.1	
PROLH-0320	3.2	40	182	360	400	195	108	36	56	10.0	1	3.0	18.0	2.2	
PROLH-0630	6.3	42	242	360	570	195	108	49	70	10.0	2	3.0	28.5	4.3	
PROLH-1000	10.0	47	379	360	630	195	108	54	87	10.0	3	3.0	46.0	6.5	

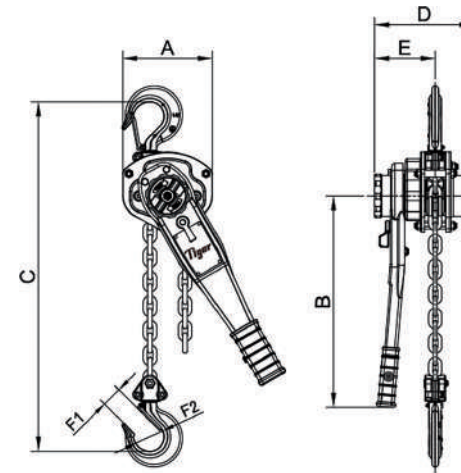



## Beam Clamps

### BCF Beam Clamps

- Range from 1t to 30t
- Versatile rigging point for hoisting equipment
- Suitable for pulling and lifting at angles across the beam
- 90° side loading with no de-ration (100% WLL)
- 15° cross loading with no de-ration (100% WLL)
- Evenly distributed loads achieved through maximum jaw surface area
- Operating temperature -40°C to +80°C
- 5:1 factor of safety

Model	Capacity (Tonnes)	Dimensions (mm)												Weight (kg)
		A	B	C	D	E	F	H	J	K	L	M	T	
BCF-0100	1.0	75-195	206-330	105	20	195	257-230	16	21	80	84	-	6	5.5
BCF-0200	2.0	75-195	206-330	105	20	195	268-242	18	21	88	95	-	8	6.5
BCF-0300	3.0	100-350	223-488	140	25	270	364-297	22	27	110	105	-	10	12.0
BCF-030S	3.0	75-190	216-333	140	20	195	267-237	22	27	110	105	-	10	9.5
BCF-0500	5.0	100-310	223-450	140	25	288	370-320	27	27	124	111	-	12	14.5
BCF-050S	5.0	75-190	216-333	140	20	195	272-243	27	27	124	111	-	12	11.0
BCF-0600	6.0	203-457	411-691	140	42	370	486-418	27	27	124	111	-	12	29.9
BCF-1000	10.0	120-350	282-527	210	30	316	400-338	32	37	83	120	-	16	26.5
BCF-1500	15.0	203-457	463-731	250	36	416	556-496	38	43.5	99	146	400	20	76.0
BCF-2000	20.0	203-457	471-768	300	50	416	603-540	45	49	126	179	408	24	100.0
BCF-3000	30.0	203-457	500-800	385	63	416	635-572	50	57	138	197	416	38	152.0

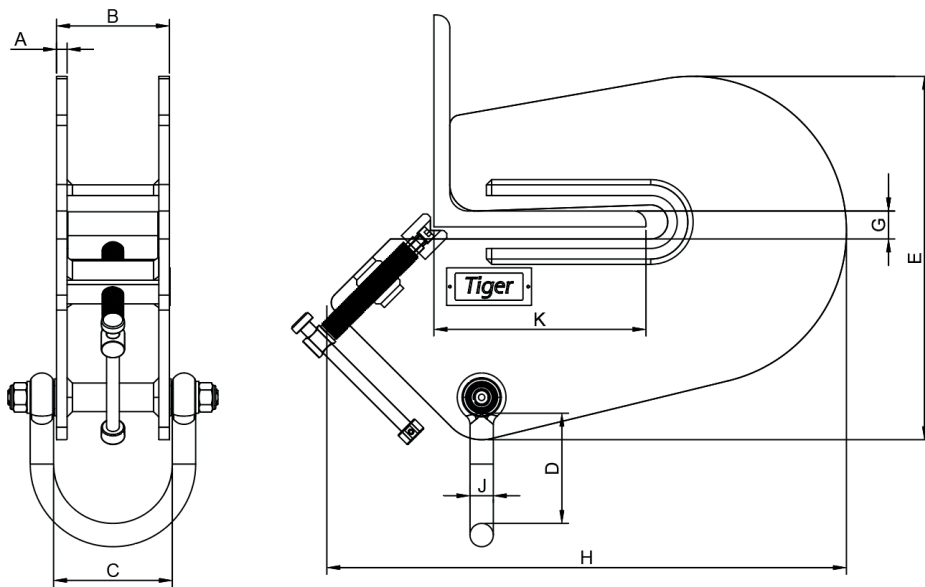

## Beam Clamps

### BCU Universal Beam Clamps

- Range from 2t to 10t
- Versatile rigging point for hoisting equipment
- Highly flexible for lifting, pulling or as a semi-permanent anchor point
- For both vertical and side loading applications
- Full rated capacity at any lifting angle
- Operating temperature -40°C to +80°C
- 5:1 factor of safety

Model	Capacity (Tonnes)	Dimensions (mm)											Weight (kg)
		A	B	C	D	E	F	G	H	J	K	L	
BCU-0200	2.0	337	58	60	68	32	203	88.5	25.4	22.5	20	76-190	10.0
BCU-0300	3.0	387	60	70	63	32	235	100	25.4	28	20	125-204	15.5
BCU-0500	5.0	524	70	74	72	32	268	120	25.4	36	44	125-305	27.0
BCU-1000	10.0	524	70	75	82	32	278	120	25.4	38	52	125-305	31.0

**Warning:**  
Do not use this equipment for lifting flat plate sections

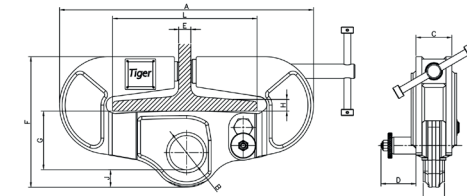

### BCA Adjustable Angle Clamps

- Range of 1t and 3t
- Versatile rigging point for hoisting equipment
- V shaped clamping jaws ensure safe, secure grip
- Accommodates a wide range of steel angle sections
- Integrated adjusting screw spindle
- Operating temperature -50°C to +50°C
- 4:1 factor of safety
- Can be used up to a maximum of 15° from the vertical



Model	Capacity (Tonnes)	Dimensions (mm)										Weight (kg)
		A	B	C	D	E	G	H	J	K		
BCA-0100	1.0	6	76.5	81	83	206	15	258	16	38-101	5.5	
BCA-0300	3.0	10	106.5	112	104	343	25	490	22	101-203	23.5	

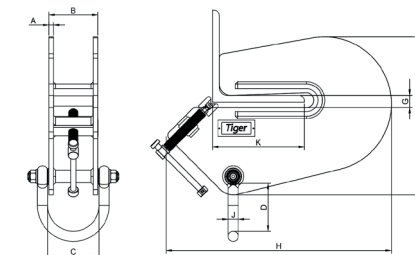



## Adjustable Beam Trolleys

### APT Adjustable Beam Trolleys - Push Travel

- Range from 1t to 10t
- Screw spindle allows easy adjustment
- High clamping force
- The anti-drop plates ensure extra safety and prevent damage to wheels when contacting end rail stoppers
- Runs on sealed ball bearings - smoother rolling, less effort and maintenance
- 5:1 factor of safety allows for use with manual or powered hoists

Model	Capacity (Tonnes)	A Track Width Range (mm)	Dimensions (mm)					Min. Curve Ratio (m)	Weight (kg)
			B	C	D	E	F		
APT-0100	1.0	75-210	391	83	16	110	81	1.0	9.5
APT-0200	2.0	75-210	391	94	18	123	89	1.3	13.5
APT-0300	3.0	75-210	403	105	22	141	112	1.5	23.0
APT-0600	6.0	105-305	521	111	27	151	125	1.5	35.5
APT-1000	10.0	160-305	606	119	32	170	83	2.7	110

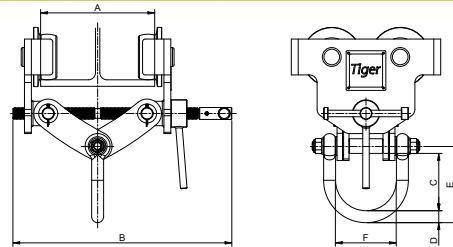

### AGT Adjustable Beam Trolleys - Geared Travel

- Range from 1t to 10t
- Screw spindle allows easy adjustment
- High clamping force
- The anti-drop plates ensure extra safety and prevent damage to wheels when contacting end rail stoppers
- Runs on sealed ball bearings - smoother rolling, less effort and maintenance
- 5:1 factor of safety allows for use with manual or powered hoists

Model	Capacity (Tonnes)	A Track Width Range (mm)	Dimensions (mm)								Min. Curve Ratio (m)	Weight (kg)
			B	C	D	E	F	G	H	J		
AGT-0300	3.0	75-210	403	105	22	141	112	288-241	99	35	1.5	28.5
AGT-0600	6.0	105-305	521	111	27	151	125	358-290	115	46	1.5	40.0
AGT-1000	10.0	160-305	606	119	32	170	83	407-352	157	33	2.7	120

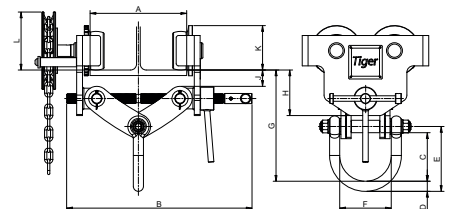

## Electric Chain Hoists

### B13 Hook Top - Dual Speed Chain Hoists

LIFTKET electric chain hoists are characterised above all by their high level of safety. The B13 chain hoist features first class material and technologies, ensuring excellent quality.

- Range from 5t to 12.5t
- Precise positioning of fragile loads thanks to ultra low speed (optional)

Model	Capacity (Tonnes)	Chain Dimension (mm)	Speed m/min	415v 3 Phase 50 Hz Motor-Output (kW)	E.D Rating (%)	No. of Falls	Weight at Std HOL (kg)
B13/00X	5	16 x 45	5.6/1.4	6.0/1.3	60/40	1	224
B13/00X	12.5	16 x 45	2.8/0.7	6.0/1.3	60/40	2	246

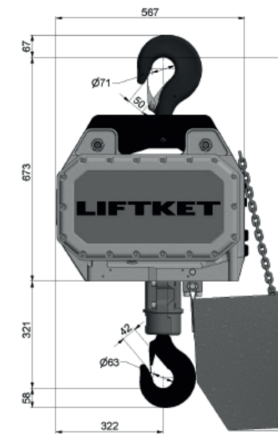

5t

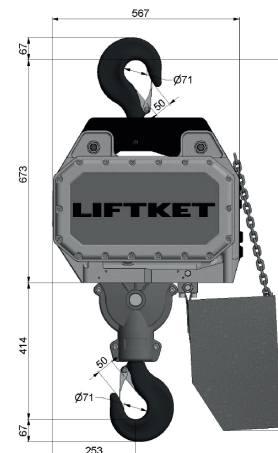
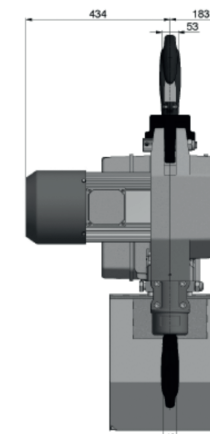

12.5t

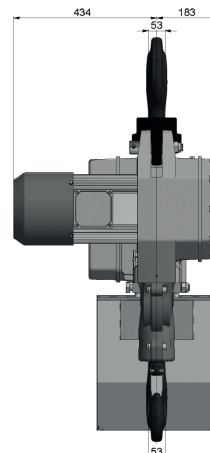



## Electric Chain Hoists

### Star Hook Top - Dual Speed Chain Hoists

LIFTKET electric chain hoists are characterised above all by their high level of safety. The STAR chain hoist features first class material and technologies, ensuring excellent quality.

- Range from 3.2t to 6.3t
- Precise positioning of fragile loads thanks to ultra low speed (optional)

Model	Capacity (Tonnes)	Chain Dimension (mm)	Speed m/min	415v 3 Phase 50 Hz Motor-Output (kW)	E.D Rating (%)	No. of Falls	Weight at Std HOL (kg)
111/54	3.2	11.3 x 31	8/2	4.4/1.1	25/25	1	118
111/54	6.3	11.3 x 31	4/1	4.4/1.1	25/25	2	130

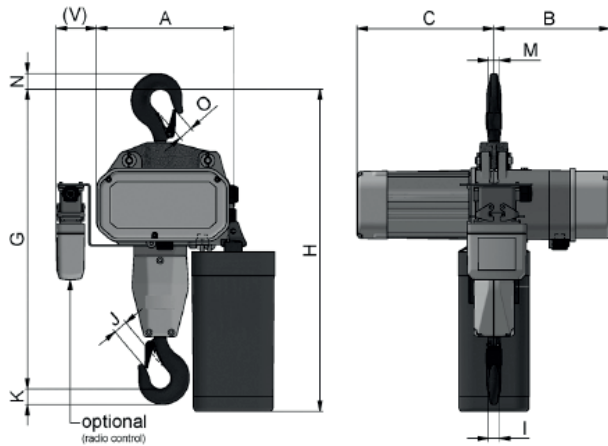

Model	Capacity (Tonnes)	Dimensions (mm)										
		A	B	C	G	I	J	K	M	N	O	V
111/54	3.2	380	291	410	732	32	30	40	45	58	42	67
111/54	6.3	380	291	410	861	45	42	58	45	58	42	67

**LIFTKET**  
WORKS 1948



## Electric Chain Hoists

### NH L Lodestar Electric Chain Hoists

The Lodestar hoist is a tough and durable electric chain hoist, designed to keep working in the most arduous applications. This hoist is recognised and proven within the hire industry as the number one hoist, where high duty, combined with long heights of lift are required.

- Range from 0.5t to 2t
- Adjustable upper and lower limit switches
- 48V control, IP65 pendant as standard
- Thermal overload protection as standard

Model	230v Single Phase 50 Hz Motor-Output (kW)	Headroom	Load Chain Diameter (mm)	Capacity (Tonnes)	No. of Falls	Lifting Speed (s) (m/min)	Weight at Std HOL (kg)	Weight for Extra Metre HOL (kg)	E.D Rating (%)
Lodestar NH F	0.31	429	6.35	0.5	1	4.9	28.0	0.87	40
Lodestar NH L	0.62	496	7.92	1.0	1	4.1	51.0	1.4	40
Lodestar NH R	0.62	613	7.92	2.0	2	2.0	59.0	2.8	40

Model	Capacity (Tonnes)	Dimensions (mm)									
		A	B	C	D	F	H	I	J	M	P
Lodestar NH F	0.5	429	201	18	298	225	25	113	113	30	168
Lodestar NH L	1.0	496	193	21	255	330	28	178	143	32	208
Lodestar NH R	2.0	613	194	29	253	329	38	179	142	33	208

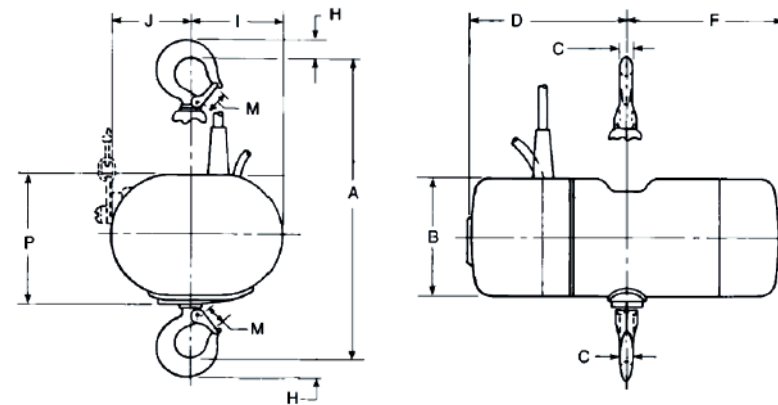

**CM LODESTAR**



## Accessories & Controls

### Wireless Remote - K Series

- Automatic channel switching allows users to select primary working frequency and secondary working frequency
- Range limiting function allows reduction of maximum distance for the transmitter to continue operating.
- Electronic key-code and automatic shut-off option programmable to prevent accidental activation of the transmitter
- Eco power management system to save battery life.
- Transmitter data logging Black Box system included, which records data and remote usage

Model	No. of Transmitters	No. of Receivers	No. of Protective Pouches	No. of Wrist Straps	Suit Models
K202	1	1	1	1	All single and two speed hoists

### Multi-Control System

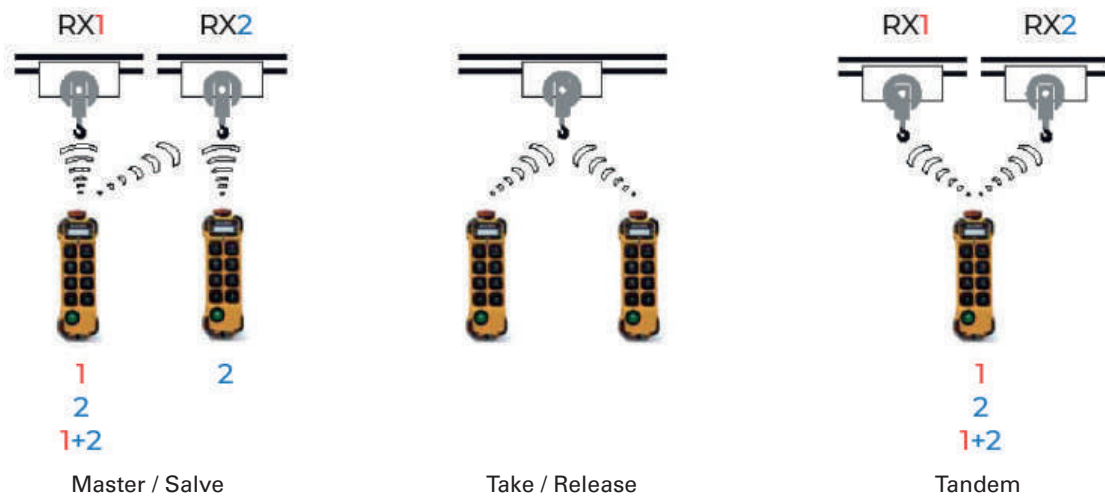

## Air Chain Hoists

### PROFI 1TI - 30TI

- Suitable for application in hazardous areas.
- Sensitive infinitely variable speed control for the precise positioning of loads
- 100 % duty rating and unlimited duty cycles
- Low headroom, lightweight
- Insensitive to dust, humidity and temperatures ranging from -20°C up to +70°C
- Planetary gear box with long-life grease lubrication, all gears made of tempered or hardened high-grade steel

### PROFI 01TI - 30TI

Model	Capacity (Tonnes)	Air Pressure (bar)	Strands of Load Chain	Motor Output (kW)	Head-room (mm)	Lifting Speed (m/min.)		Lowering Speed (m/min.)		Air Consumption at Full Load (m <sup>3</sup> /min)		Air Connection	Hose Dimension (Ø inside mm)	Weight @ std HOL (kg)	Load Chain Dia. (mm)	Weight for Additional One Metre of Lift (kg)	Sound Level at Full Load dB(A)	
						w/o Load	Full Load	Full Load	Lifting	Lowering	Lifting						Lowering	
1TI	1	6	1	1.0	450	11	5.5	11.0	1.2	1.5	G½"	13	28	7x21	1.0	76	78	
2TI	2	6	2	1.0	498	5.5	2.7	5.5	1.2	1.5	G½"	13	34	7x21	1.0	76	78	
3TI	3.2	6	1	3.5	593	10	5.0	10.8	4.0	5.5	G¾"	19	86	13x36	3.8	78	80	
6TI	6.3	6	2	3.5	674	5.0	2.5	5.4	4.0	5.5	G¾"	19	110	13x36	3.8	78	80	
10TI	10	6	2	3.5	813	3.2	1.6	3.4	4.0	5.5	G¾"	19	156	16x45	5.8	78	80	
16TI	16	6	3	3.5	898	2.0	1.0	2.1	4.0	5.5	G¾"	19	240	16x45	5.8	78	80	
30TI	30	6	2	6.3	1260	2.4	1.0	2.8	6.5	2.9	G1½"	35	550	23.5x66	12.2	78	82	

Model	Capacity (Tonnes)	Dimensions (mm)							
		A*	B	C	D	E1	E2	F	G
1TI	1	450	288	145	297	28	28	137	176
2TI	2	498	336	145	297	28	28	137	183
3TI	3.2	593	373	233	483	40	30	187	233
6TI	6.3	674	454	233	483	40	40	154	233
10TI	10	813	548	308	575	44	44	197	306
16TI	16	898	598	382	692	53	53	199	308
30TI	30	1260	827	450	900	70	70	270	445

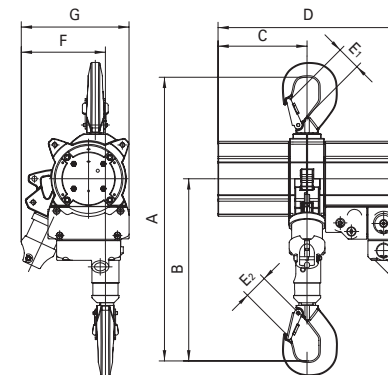

# Aluminium Gantries

## PORTA-GANTRY - 2t to 5t



- Lightweight, portable and safe, the innovative and unique PORTA-GANTRY lifting system range is designed for easy transport, rapid assembly and safe use
- The world's first WLL 5t capacity portable gantry. A range of Lift Height options and beam lengths are available
- Wind up jacking legs available for use on uneven ground

### Assembled PORTA-GANTRY dimensions (see diagram on next page)

Capacity (kg)	Frame Size	D Height to Lifting Eye (mm)		E Height Increment (mm)	F Height to Top of Beam (mm)		G Width (mm)	H Height to Top of Roller (mm)		A-Frame Weight (kg)	Castor Ø
		Min.	Max.		Min.	Max.		Min.	Max.		
2000	S	1595	2345	5 x 150	1925	2675	1212	2007	2757	35	150
	I	2178	3178	5 x 200	2499	3499	1726	2581	3581	50	200
	T	2869	4069	6 x 200	3199	4399	2011	3281	3381	56	200
3000	I	2178	3178	5 x 200	2499	3499	1726	2581	3581	73	200
	T	2869	4069	6 x 200	3199	4399	2021	3281	4481	85	200
	XT	3817	5017	6 x 200	4147	5347	2557	4230	5430	91	200
	XX T	3917	5517	8 x 200	4248	5848	2733	4330	5930	97	200
5000	I	2181	3181	5 x 200	2592	3592	1736	2717	3717	99*	200
	T	2849	4049	6 x 200	3287	4487	2021	3412	4612	109*	200
	XT	3800	5000	6 x 200	4238	5438	2557	4362	5562	101	200

### Beam Data

Standard Beam Lengths (mm)									
	2500	3000	3920	4570	5500	6000	8400	9000	
Clear Operating Span (mm)									
2000	1580	2080	3000	3650	4580	5080	7480	-	
3000	1580	2080	3000	3650	4580	5080	7480	-	
5000	1580	2080	3000	3650	4580	-	-	-	

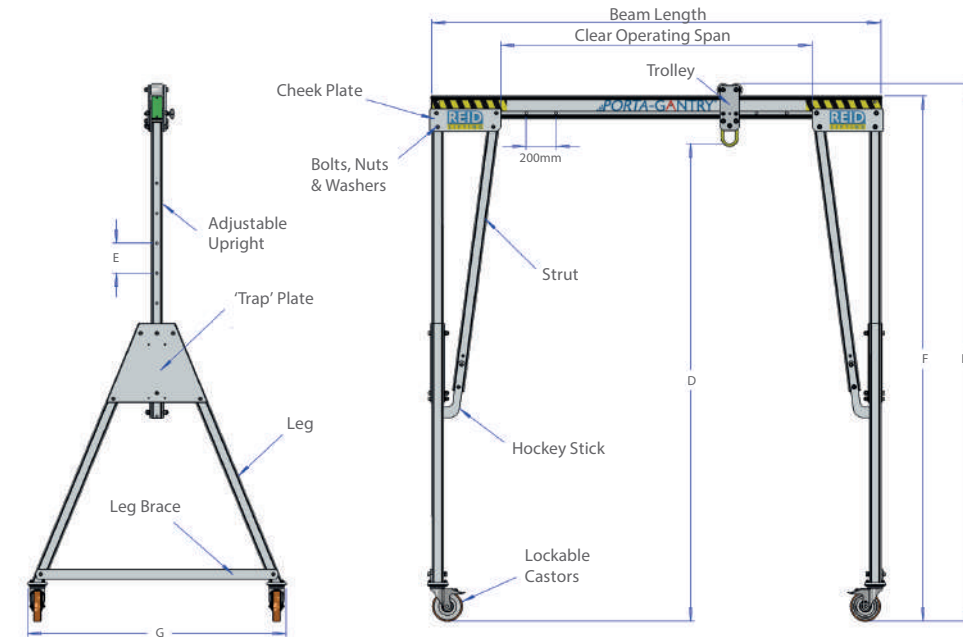

Trolley fully encapsulated for safety. Beam lengths up to 9000mm (WLL dependent).

Dimensions use standard Master Link Trolley, other options available to increase resulting height of lift (HOL) and to assist with load movement. \*Weight includes stabiliser legs  
 Frame sizes: S = small, M = medium, I = intermediate, T = tall, XT = extra tall, XX T = extra extra tall





# 27

## PULLING

- 28 Electric Winches
- 29 Tirthor Machines, Ropes & Accessories
- 30 Load Equalising Dollies
- 31 Rotational Load Skates



Unrivalled Lifting  
Precision



## Electric Winches

### Comeup CWG Series

- Electromagnetic spring-applied failsafe brake
- Heavy duty high efficiency ball bearing on all running surfaces
- Planetary gears for maximum mechanical efficiency.
- Rated capacity limiter limits driving power of the motor to prevent overloading of the winch
- Rope sold separately
- All winches come in their own dedicated winch frame

Model	Rated Capacity (kg)	Lifting Speed (m/min)	Phase Voltage	Wire Rope (ø mmxm)	Max. Lifting Height (m)	Net Weight (kg)
CP-500	500	10- 15	240v x 1 Phase	7 x 60	58	55
CWG-30565	1,100	14- 25	415v x 3 Phase	12 x 100	97	250
CWG-30750	2,200	6.9- 12.6	415v x 3 Phase	16 x 100	97	400
CWG-31500	3,500	5.8- 8	415v x 3 Phase	18 x 150	144	800
CWG-34000	5,000	8- 12.2	415v x 3 Phase	22.4 x 200	192	1380

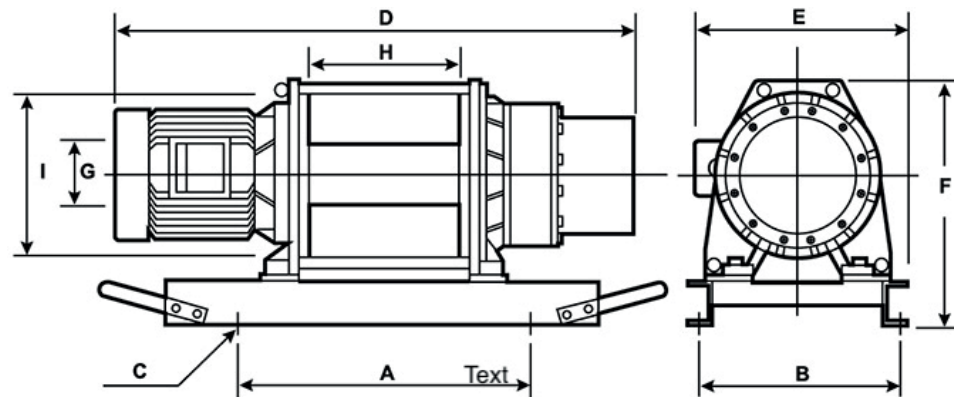

Model	A	B	C	D	E	F	G	H	I
CP-500	267	156	4 x ø 13.5	694	260	299	-	-	-
CWG-30565	620	425	4 - ø 19	1,120	470	520	140	312	320
CWG-30750	600	499	4 - ø 22	1,246	565	658	178	312	410
CWG-31500	847	680	8 - ø 28	1,439	740	860	356	405	570
CWG-34000	920	680	8 - ø 32	1,860	740	905	324	680	570

**COMEUP  
WINCH**

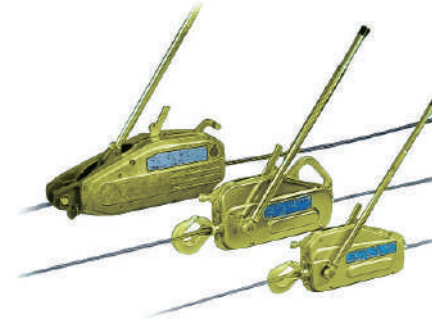

## Tirfor Machines, Ropes & Accessories

### Tirfor TU Heavy Duty Series (manually operated)

- For lifting, pulling and positioning heavy loads
- Unrivalled in terms of durability and sturdiness
- Extra shear pins in handle
- Rope sold separately
- T5 medium duty machines also available

Model	WLL (kg)	Maxiflex Rope Dia. (mm)	Rope Breaking Strain (kg)	Machine Weight (kg)	(20m) Rope Weight (kg)
TU8	800	8.3	5500	8.4	6.1
TU16	1600	11.5	9200	20.0	13.1
TU32	3200	16.3	16,000	26.8	23



### Maxiflex Wire Ropes

- Maxiflex ropes have been specifically designed to suit Tirfor products
- The rope is manufactured to extremely high tolerances which are necessary for the reliable operation of the product mechanism inside the machine, especially when lowering under load
- Using Maxiflex Ropes is part of the certification of the machine

Maxiflex Wire Rope	TU-8 /T508 Fitted with Hook 8.3mm Dia.	TU-16 /T516 Fitted with Hook 11.3mm Dia.	TU-32 /T532 /T35 Fitted with Hook 16.3mm Dia.
Length (m)	20- 80	20- 80	20- 80

### Other lengths available on request

Up to 80m - 5 strand rope. All Tirfor machines are supplied fully tested and certified in accordance with the statutory regulations. The TU16H and TU32H Tirfor machines must not be used for man-riding applications.



## Load Equalising Dollies

### Hilman Tri-Glide System

- Steerable front unit can be used with handle or attached to forklift
- Adjustable spreader bar for fitting under heavy loads with a wide range of widths
- A stable and efficient solution for moving heavy loads
- 360 degree turntable with non-slip swivel pad allows the rollers to rotate under the load, making pushing and pulling more precise
- A low profile keeps the load close to the ground for safe movement
- Rear dollies to allow for better tracking when moving

Model	System Capacity (t)	Front Capacity (t)	Rear Capacity per Roller (t)	Wheel Type	Wheel Count	Height w/ pad (mm)	Height w/o pad (mm)	Weight (kg)	Handle Length (mm)	Alignment Bar Length (mm)
KTG-20P	20	10	5	Poly	16/16	114	102	90	1257	1524
KTG-40P	40	20	10	Poly	16/16	140	133	212	1162	1829
KTG-80P	80	40	20	Poly	32/32	197	178	497	1146	2438



## Load Skates

### Hilman ERS Series

- High strength chain construction to withstand stresses of turning
- Serrated side plates to maintain a firm grip when in open top
- Hardened precise chain rolls for durability and long life
- Variety of top swivel options available

Model	Rated Capacity per Skate (t)	Length (mm)	Width (mm)	Height (mm)	Weight (kg)	Contact Rolls
5-ERS	5	219	135	70	9	5
10-ERS	10	264	132	86	13	5
25-ERS	25	400	184	121	36	5
100-ERS	100	584	200	143	75	7

Swivel Locking Diamond Top	Swivel Locking Padded Top	Fits Individual Roller Part	Padded (P) Style Height (mm)	Diamond (D) Style Height (mm)	Attachment Width (mm)	Length (mm)	Weight (kg)
T-5-LD	T-5-LP	5-ERS	119	113	149	273	6
T-10-LD	T-10-LP	10-ERS	135	129	149	318	6
T-25-LD	T-25-LP	25-ERS	202	179	203	472	19
T-100-LD	T-100-LP	100-ERS	224	202	213	645	21

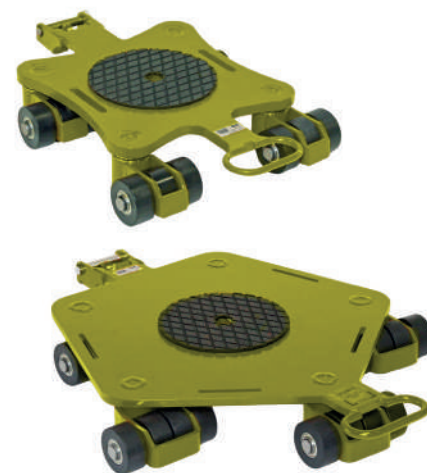

## Rotational Load Skates

### Jung JKB Series

- High load capacity at low weight
- Bearing supported swivelling rollers allow 360° manoeuvrability
- The double roller system reduces rolling and turning resistance to a minimum
- Pulling handle and connecting bars as available
- All the trolleys are outfitted with a platform centre hole to allow attachment to the load
- Using the slits in the platform the trolleys JKB 3 - 7,5 can be affixed to the load with standard tie-down belts
- Same height trolleys provide interchangeability. Mix and match revolving trolleys with Series K transport trolleys

Model	Rated Capacity (kg)	No. of Castors	Castor Type	Height (mm)	Cassette Dimensions (mm)	Weight (kg)
JKB 4 K	4,000	12	Heavy Duty	110	675 x 475	43
JKB 7.5 K	7,500	20	Heavy Duty	110	895 x 740	63.5



# 33

# JACKING

- 34 Jacks
- 35 Hydraulic Cylinders
- 40 Skidding System
- 41 Electric Hydraulic Power Units
- 42 Hydraulic Pumps
- 43 Hydraulic Accessories



Unrivalled Lifting  
Precision

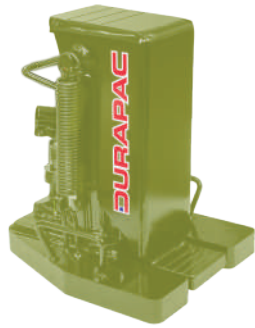

## Jacks

### TJ Series

- Lightweight construction
- Stroke limiting device (Positive Stop)
- Available as plain ram jack, claw jack or screwed ram and locking collar
- Range from 2t to 25t capacity
- Stroke lengths 118mm to 230mm
- Internal safety overload device

Model	Jack Capacity Tonnes (Max)	A Jack Width (mm)	B Jack Depth (mm)	C Toe Length (mm)	D Toe Width (mm)	E Collapsed Height (mm)	F Min. Toe Height (mm)	Stroke (mm)	Weight (kg)
TJ-2	2	145	185	45	50	235	14	118	9.0
TJ-5	5	185	270	55	70	295	25	123	23.0
TJ-5E	5	140	320	53	45	365	25	205	23.0
TJ-10	10	230	295	60	80	330	30	141	32.0
TJ-10E	10	165	325	55	70	455	30	230	33.0
TJ-15	15	250	315	58	100	340	28	165	48.0
TJ-25	25	280	345	65	145	382	38	129	80.0

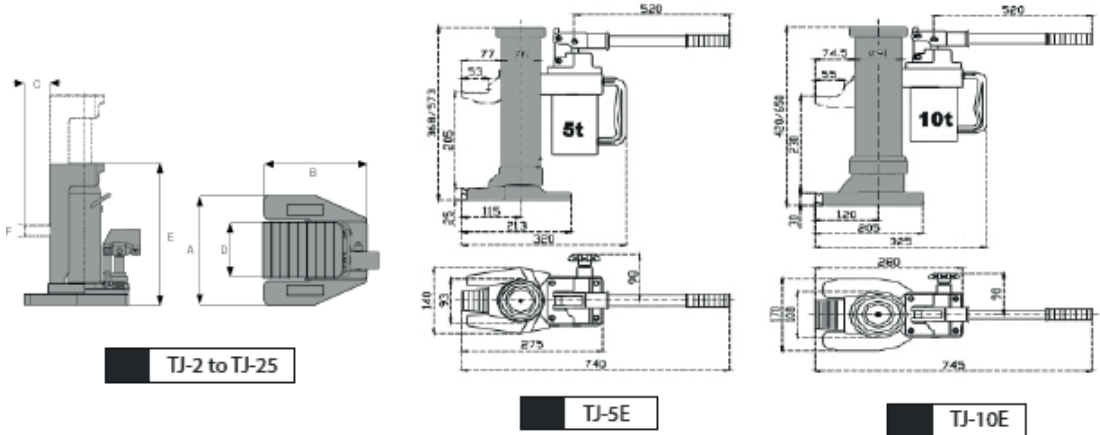

## Hydraulic Cylinders

### RG Series - Single Acting - Spring Return Cylinders

- Single acting load return
- Range from 5t to 100t capacity
- Stroke length 16mm to 362mm
- Working pressure 700 Bar

Model	Cyl-inder Cap. Tonnes (Max)	Stroke (mm)	Cyl Eff Area (cm <sup>2</sup> )	Oil Cap (cm <sup>3</sup> )	A Col-lapsed Height (mm)	B Ex-tended Height (mm)	D Out-side Dia. (mm)	E Cyl-inder Bore Dia (mm)	F Piston Rod Dia. (mm)	H Base to Adv. Port (mm)	J Sad-dle Dia. (mm)	K Sad-dle Protru-sion from Piston (mm)	O Piston Rod Internal Thread (mm)	P Piston Rod Thread Length (mm)	W Collar Thread	X Collar Thread Length (mm)	Weight (kg)
RG-50	5	16	6.5	10	41	57	58	28.7	25.4	19	**	**	**	**	**	-	1.0
RG-51	5	25	6.5	16	110	135	38	28.7	25.4	19	25	6	3/4"-16UNF	14	1 1/2"-16UN	28	1.0
RG-53	5	76	6.5	49	165	241	38	28.7	25.4	19	25	6	3/4"-16UNF	14	1 1/2"-16UN	28	1.5
RG-55	5	127	6.5	82	215	342	38	28.7	25.4	19	25	6	3/4"-16UNF	14	1 1/2"-16UN	28	1.9
RG-57	5	177	6.5	114	273	450	38	28.7	25.4	19	25	6	3/4"-16UNF	16	1 1/2"-16UN	28	2.4
RG-59	5	232	6.5	150	323	555	38	28.7	25.4	19	25	6	3/4"-16UNF	16	1 1/2"-16UN	28	2.8
RG-101	10	26	14.5	38	89	115	57	42.9	38.1	19	-	-	#10-24UNC	6	2 1/4"-14UN	26	1.8
RG-102	10	54	14.5	78	121	175	57	42.9	38.1	19	35	6	1"-8UNC	19	2 1/4"-14UN	26	2.3
RG-104	10	105	14.5	152	171	276	57	42.9	38.1	19	35	6	1"-8UNC	19	2 1/4"-14UN	26	3.3
RG-106	10	156	14.5	226	247	403	57	42.9	38.1	19	35	6	1"-8UNC	19	2 1/4"-14UN	26	4.4
RF-108	10	203	14.5	294	298	501	57	42.9	38.1	19	35	6	1"-8UNC	19	2 1/4"-14UN	26	5.4
RG-1010	10	257	14.5	372	349	606	57	42.9	38.1	19	35	6	1"-8UNC	19	2 1/4"-14UN	26	6.4
RG-1012	10	304	14.5	440	400	704	57	42.9	38.1	19	35	6	1"-8UNC	19	2 1/4"-14UN	26	6.8
RG-1014	10	356	14.5	515	460	806	57	42.9	38.1	19	35	6	1"-8UNC	19	2 1/4"-14UN	26	8.2
RG-151	15	25	20.3	51	124	149	69	50.8	41.4	19	38	9	1"-8UNC	25	2 3/4"-16UN	30	3.3
RG-152	15	51	20.3	103	149	200	69	50.8	41.4	19	38	9	1"-8UNC	25	2 3/4"-16UN	30	4.1
RG-154	15	101	20.3	205	200	301	69	50.8	41.4	19	38	9	1"-8UNC	25	2 3/4"-16UN	30	5.0
RG-156	15	152	20.3	308	271	423	69	50.8	41.4	25	38	9	1"-8UNC	25	2 3/4"-16UN	30	6.8
RG-158	15	203	20.3	411	322	525	69	50.8	41.4	25	38	9	1"-8UNC	25	2 3/4"-16UN	30	8.2
RG-1510	15	254	20.3	515	373	627	69	50.8	41.4	25	38	9	1"-8UNC	25	2 3/4"-16UN	30	9.5
RG-1512	15	305	20.3	618	423	728	69	50.8	41.4	25	38	9	1"-8UNC	25	2 3/4"-16UN	30	10.9
RG-1514	15	356	20.3	721	474	830	69	50.8	41.4	25	38	9	1"-8UNC	25	2 3/4"-16UN	30	11.8

# Hydraulic Cylinders

## RG Series - Single Acting - Spring Return Cylinders Continued

Model	Cylinder Cap. Tonnes (Max)	Stroke (mm)	Cyl Eff Area (cm <sup>2</sup> )	Oil Cap (cm <sup>3</sup> )	A Collapsed Height (mm)	B Extended Height (mm)	D Outside Dia. (mm)	E Cylinder Bore Dia. (mm)	F Piston Rod Dia. (mm)	H Base to Adv. Port (mm)	J Saddle Dia. (mm)	K Saddle Protrusion from Piston (mm)	O Piston Rod Internal Thread (mm)	P Piston Rod Thread Length (mm)	W Collar Thread	X Collar Thread Length (mm)	Weight (kg)
RG-251	25	26	33.2	86	139	165	85	65.0	57.2	25	50	10	1½"-16UN	25	3½"-12UN	49	5.9
RG-252	25	50	33.2	166	165	215	85	65.0	57.2	25	50	10	1½"-16UN	25	3½"-12UN	49	6.4
RG-254	25	102	33.2	339	215	317	85	65.0	57.2	25	50	10	1½"-16UN	25	3½"-12UN	49	8.2
RG-256	25	158	33.2	524	273	431	85	65.0	57.2	25	50	10	1½"-16UN	25	3½"-12UN	49	10.0
RG-258	25	210	33.2	697	323	533	85	65.0	57.2	25	50	10	1½"-16UN	25	3½"-12UN	49	12.2
RG-2510	25	261	33.2	866	374	635	85	65.0	57.2	25	50	10	1½"-16UN	25	3½"-12UN	49	14.1
RG-2512	25	311	33.2	1032	425	736	85	65.0	57.2	25	50	10	1½"-16UN	25	3½"-12UN	49	16.3
RG-2514	25	362	33.2	1205	476	838	85	65.0	57.2	25	50	10	1½"-16UN	25	3½"-12UN	49	17.7
RG-308	30	209	42.1	878	387	596	101	73.2	57.2	57	50	10	1½"-16UN	25	3½"-12UN	49	18.1
RG-502	50	51	71.2	363	176	227	127	95.3	79.5	33	71	2	-	-	5"-12UN	55	15.0
RG-504	50	101	71.2	719	227	328	127	95.3	79.5	33	71	2	-	-	5"-12UN	55	19.1
RG-506 †	50	159	71.2	1,132	282	441	127	95.3	79.5	35	71	2	-	-	5"-12UN	55	23.1
RG-5013	50	337	71.2	2,400	460	797	127	95.3	79.5	35	71	2	-	-	5"-12UN	55	37.6
RG-756	75	156	102.6	1,600	285	441	146	114.3	95.3	30	71	5	-	-	5½"-12UN	44	29.5
RG-7513	75	333	102.6	3,415	492	825	146	114.3	95.3	30	71	5	-	-	5½"-12UN	44	59.0
RG-1104	100	102	133.3	1,354	205	306	177	130.3	104.9	30	71	2	-	-	6¾"-12UN	44	33.1
RG-1006	100	168	133.3	2,239	357	525	177	130.3	104.9	41	71	2	-	-	6¾"-12UN	44	59.0
RG-1008	100	203	133.3	2,708	357	560	177	130.3	104.9	41	71	2	-	-	6¾"-12UN	44	61.0
RG-10010	100	260	133.3	3,465	449	709	177	130.3	104.9	41	71	2	-	-	6¾"-12UN	44	72.6

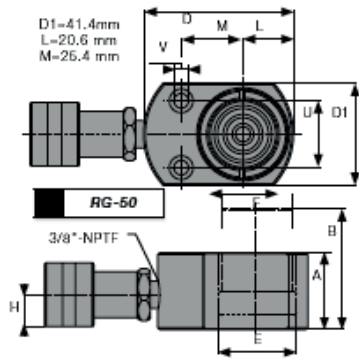
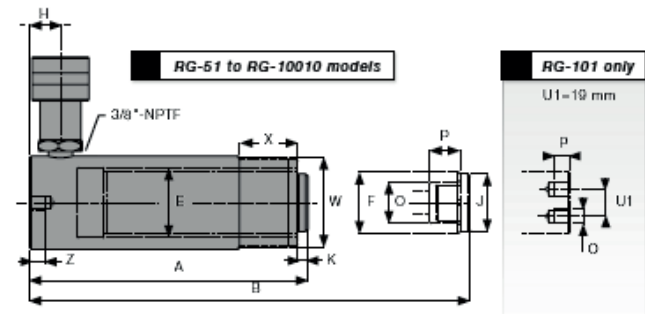

# Hydraulic Cylinders

## RSLC Series - Single Acting - Locking Cylinders

- Single acting load return
- Range from 50t to 1000t capacity
- Stroke length 50mm to 300mm
- Working pressure 700 Bar

Model	Cylinder Cap. Tonnes (Max)	Stroke (mm)	Cyl Eff Area (cm <sup>2</sup> )	Oil Cap (cm <sup>3</sup> )	A Collapsed Height (mm)	B Extended Height (mm)	D Outside Dia (mm)	E Cylinder Bore Dia. (mm)	F Piston Rod Dia. (mm)	H Base to Advance Port (mm)	J Saddle Dia (mm)	K Saddle Protrusion from Piston (mm)	L Depth of Piston Rod Hole (mm)	S Lock Ring Height (mm)	Weight (kg)
RSLC-502	50	50	70.9	355	164	214	125	95.0	TR95x4	30	71	2	13	36	15.0
RSLC-504	50	100	70.9	708	214	314	125	95.0	TR95x4	30	71	2	13	36	20.0
RSLC-506	50	150	70.9	1,063	264	414	125	95.0	TR95x4	30	71	2	13	36	25.0
RSLC-508	50	200	70.9	1,417	314	514	125	95.0	TR95x4	30	71	2	13	36	30.0
RSLC-5010	50	250	70.9	1,771	364	614	125	95.0	TR95x4	30	71	2	13	36	35.0
RSLC-5012	50	300	70.9	2,125	414	714	125	95.0	TR95x4	30	71	2	13	36	40.0
RSLC-1002	100	50	132.7	664	187	237	165	165	TR130x6	30	71	2	13	44	30.0
RSLC-1004	100	100	132.7	1,327	237	337	165	165	TR130x6	30	71	2	13	44	39.0
RSLC-1006	100	150	132.7	1,990	287	437	165	165	TR130x6	30	71	2	13	44	48.0
RSLC-1008	100	200	132.7	2,653	337	537	165	165	TR130x6	30	71	2	13	44	56.0
RSLC-10010	100	250	132.7	3,317	387	637	165	165	TR130x6	30	71	2	13	44	64.0
RSLC-10012	100	300	132.7	3,980	437	737	165	165	TR130x6	30	71	2	13	44	73.0
RSLC-1502	150	50	198.6	993	209	259	205	205	TR159x6	39	130	2	25	44	53.0
RSLC-1504	150	100	198.6	1,985	259	359	205	205	TR159x6	39	130	2	25	44	66.0
RSLC-1506	150	150	198.6	2,977	309	459	205	205	TR159x6	39	130	2	25	44	78.0
RSLC-1508	150	200	198.6	3,969	359	559	205	205	TR159x6	39	130	2	25	44	92.0
RSLC-15010	150	250	198.6	4,961	409	659	205	205	TR159x6	39	130	2	25	44	104.0
RSLC-15012	150	300	198.6	5,954	459	759	205	205	TR159x6	39	130	2	25	44	117.0

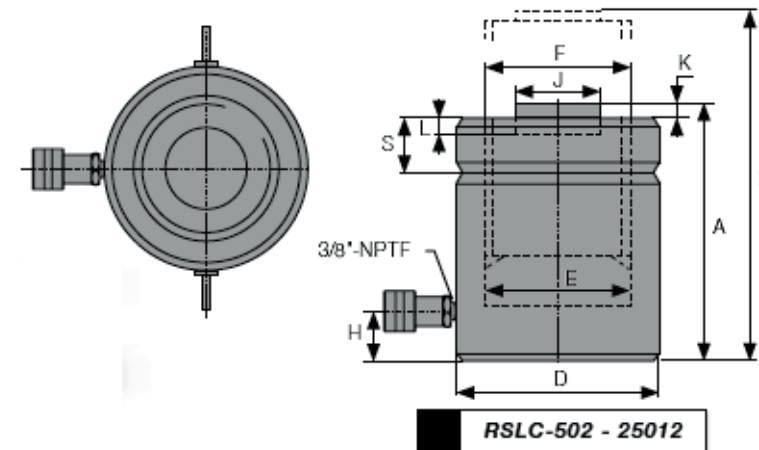



## Hydraulic Cylinders

### RLP Series - Single Acting - Low Profile Cylinders

- Spring-assisted return
- Optional piston rod saddles
- Collar thread protector supplied as standard
- Range from 10t to 100t capacity
- Stroke lengths from 38mm to 62mm
- Working pressure 700 Bar

Model	Cylinder Cap. Tonnes (Max)	Stroke (mm)	Cyl Eff Area (cm <sup>2</sup> )	Oil Cap (cm <sup>3</sup> )	A Collapsed Height (mm)	B Extended Height (mm)	D Outside Dia. (mm)	E Cylinder Bore Dia. (mm)	F Piston Rod Dia. (mm)	H Base to Advance Port (mm)	K Saddle Protrusion from Cylinder Body (mm)	O Tilt Saddle Mounting Thread Length (mm)	P Tilt Saddle Mounting Thread Length (mm)	U Bolt Circle Diameter (mm)	Weight (kg)
RLP-101	10	38	14.5	55	88	126	69	42.9	38.1	17	5	M4 x 0.7	8	26	4.1
RLP-201	20	45	28.7	129	98	143	92	60.5	50.8	17	3	M5 x 0.8	8	39	5.0
RLP-302	30	62	42.1	261	117	179	101	73.2	66.5	19	3	M5 x 0.8	8	39	6.8
RLP-502	50	60	62.1	372	122	182	124	88.9	69.8	23	2	M5 x 0.8	8	39	10.9
RLP-1002	100	57	126.7	722	141	198	165	127.0	92.2	31	1	M8 x 1.25	10	55	22.7

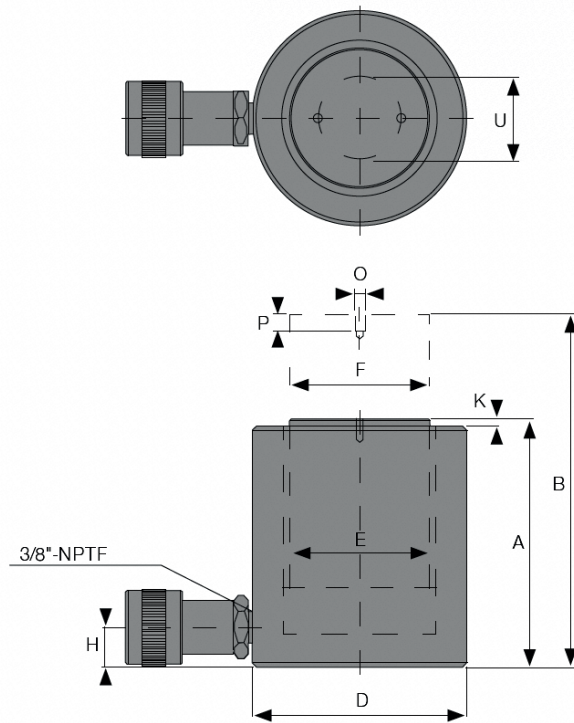

## Hydraulic Cylinders

### RHS Series - Single Acting - Spring Return Hollow Piston Rod



Model	Cylinder Cap. Tonnes (Max)	Stroke (mm)	Cyl Eff Area (cm <sup>2</sup> )	Oil Cap (cm <sup>3</sup> )	A Collapsed Height (mm)	B Extended Height (mm)	D Outside Dia. (mm)	E Cylinder Bore Dia. (mm)	F Piston Rod Dia. (mm)	H Base to Advance Port (mm)	K Saddle Protrusion from Cylinder Body (mm)	O Piston Rod Internal Thread	P Piston Rod Thread Length (mm)	U Bolt Circle Diameter (mm)	Weight (kg)
RHS-120	12	8	17.9	14	55	63	69	54.1	35.1	9	-	3/4"-16UNF	16	50.8	2.0
RHS-121	12	42	17.9	75	120	162	69	54.1	35.1	19	-	-	-	-	2.8
RHS-123	12	76	17.9	135	184	260	69	54.1	35.1	19	-	3/4"-16UNF	-	50.8	4.4
RHS-202	20	49	30.7	149	162	211	98	73.1	54.1	19	6.9	1-9/16"-16UN	19	82.6	7.7
RHS-204	20	102	30.7	311	242	344	98	73.1	54.1	19	6.9	1-9/16"-17UN	19	82.6	10.0
RHS-206	20	155	30.7	472	306	461	98	73.1	54.1	19	6.9	1-9/16"-16UN	19	82.6	14.1
RHS-302	30	64	46.6	297	178	242	114	88.9	63.5	22	9.7	1-13/16"-16UN	22	92.2	10.9
RHS-304	30	102	46.6	474	233	335	114	88.9	63.5	22	9.7	1-13/16"-17UN	22	92.2	14.0
RHS-306	30	155	46.6	720	330	485	114	88.9	63.5	25	9.7	1-13/16"-18UN	22	92.2	21.8
RHS-602	60	76	82.3	629	247	323	159	123.9	91.9	31	12.7	2-3/4"-16UN	19	130.3	28.1
RHS-604	60	103	82.3	838	286	389	159	123.9	91.9	31	12.7	2-3/4"-16UN	19	130.3	30.0
RHS-606	60	153	82.3	1,266	323	476	159	123.9	91.9	31	12.7	2-3/4"-16UN	19	130.3	35.4
RHS-1003	100	76	133.0	1,011	254	330	212	165.1	127.0	38	12.7	4"-16UN	25	177.8	63.0
RHS-1006	100	152	133.0	2,026	373	525	212	165.1	127.0	54	12.7	4"-16UN	25	177.8	73.0

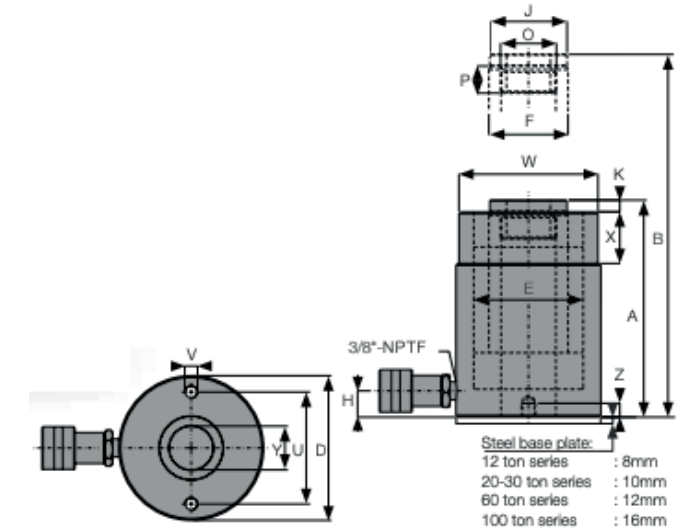

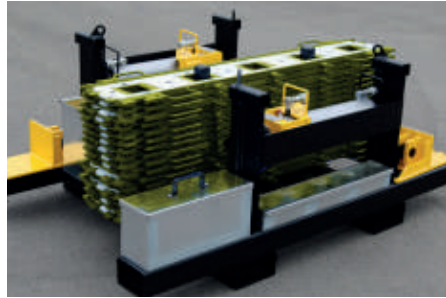

Full system in storage box.

## Skidding Systems

### Low Profile XLP150

The XLP150 is one of the most versatile skidding systems ever designed. It is completely hand-portable and is ideal for confined work spaces, indoor applications such as hospitals and laboratories - anywhere a clean, self contained and compact system is essential. It performs just as well in harsh environments or underground.

- Simple switch from push to pull
- Ideal for limited clearance/access

Model	Skidding Push Capacity (t)	Skidding Pull Capacity (t)	Skidding System Height (mm)	Cylinder Capacity Push (t)	Cylinder Capacity Pull (t)	Cylinder Push/Pull Stroke (mm)	Cylinder Hydraulic Couplers	Skidding Speed (m/hr)	System Coefficient of Friction	Surface Material	Max Slope	Alignment Tolerance (mm)	Max Operating Pressure (bar)
XLP150	227	136	32	27	11.5	362	Enerpac CR400 (female)	8.8	10-15%	UHMW Polyethylene	+/- 2%	+/- 6	700
XLP80 (Cylinder Only)	72	36	32	9	4.5	355	Enerpac CR400 (female)	24.2	10-15%	UHMW Polyethylene	+/- 2%	+/- 6	700

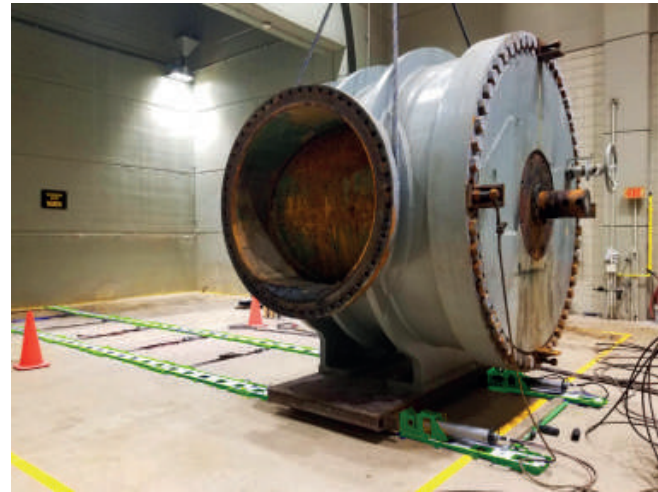

Components	Length (mm)	Width (mm)	Height (mm)	Weight (kg)
Track Section	1520	390	29	29
Slider Plate 1'	300	200	10	3.4
Slider Plate 2'	610	200	10	7.9
Slider Plate 4'	1220	200	10	18
Push/Pull Head	483	200	165	14
Cylinder Assembly XLP150	660	200	203	36
Cylinder Assembly XLP80	-	-	-	-
Full System in Storage Box	1930	1220	790	948

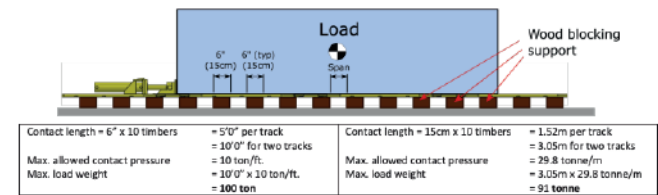

## Electric Hydraulic Power Units

### PEM Series

- Remote pendant control
- Electric induction motor
- Directional control valves
- Adjustable pressure relief valve
- Precision pump
- Steel oil reservoir



Model	Flow Rate (Lpm)		Pressure Rating (bar)		Motor (kW)	Voltage (50 Hz)	Amps	Remote Pendant	Valve Type (3/8" NPTF Ports)	Usable Oil Capacity (L)	Approx. Dry Weight (kg)	Approx. Dimensions (mm)
	1st Stage	2nd Stage	1st Stage	2nd Stage								
PEM-8413-DJL	10.5	0.9	50	700	0.84	240	10	Motor On/Off	4w/3p Manual	10	25	320W x 400L x 565H
PEM-8423-DJL	10.5	0.9	50	700	0.84	240	10	Motor On/Off	4w/3p Manual	20	41	368W x 490L x 715H

## Hydraulic Pumps

### HP - Manually Operated Pumps



- Oil reservoir capacity up to 10 litres
- Externally adjustable pressure relief valve
- Factory set safety relief valve
- Changeover pressure for two speed models is 14 Bar
- Single or two speed operation
- Choice of control valves (2 way / 4 way)
- Working pressure 700 Bar

Model	Operation	Used With Cylinder	Valve Type	Pressure Rating (bar)		Usable Oil Cap (cc)	Oil Volumes per Stroke		Oil Port Thread	Max. Handle Effort (kg)	Weight with Oil (kg)
				1st Stage	2nd Stage		1st Stage	2nd Stage			
P-270	Two Speed	S/A	2Way	13.8	700	700	13.0	2.8	3/8"-NPTF	180	7.3
P-2260	Two Speed	S/A	2Way	28.0	700	2,600	30.0	3.0	3/8"-NPTF	180	13.5

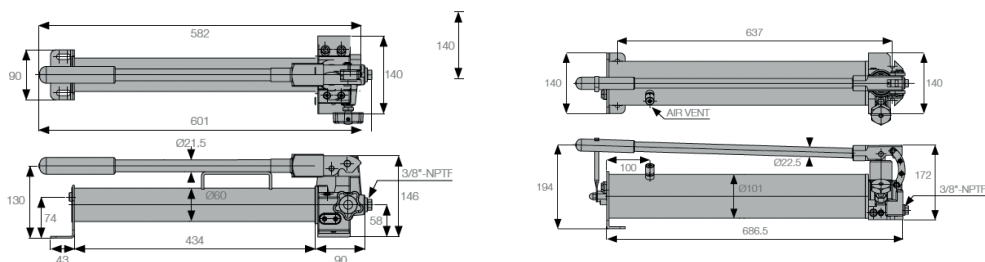

Model	Usable Oil (cc)	Pressure Stage	mm of movement for each stroke of the pump handle	Cylinder Capacity (ton)												
				5	10	15	20	25	30	50	75	100	150	200	250	
P-270	700	1st		20.8	9.0	6.4	4.6	3.9	3.1	1.8	1.3	1.0	0.6	-	-	
-	-	2nd		4.5	1.9	1.4	1.0	0.8	0.7	0.4	0.3	0.2	0.1	-	-	
P-2260	2,600	1st		48.0	20.7	14.8	10.6	9.0	7.1	4.2	2.9	2.3	1.5	1.0	-	
-	-	2nd		4.8	2.1	1.5	1.1	0.9	0.7	0.4	0.3	0.2	0.2	0.1	-	



## Hydraulic Accessories

### HM2C & 4C – Controlled Manifolds



- These controlled manifold units are designed specifically to allow easy control of the direction of flow of the hydraulic fluid, within a single acting or double acting system
- They are mounted in a sturdy framework and are available as 2 outlet or 4 outlet options and are supplied with pressure gauges, reading 0 -700 Bar, fitted to each outlet port
- All models are fitted with quick connect couplings on all inlet and outlet ports, including the 2 way and 4 way open manifold return flow lines on double acting versions

Model	VMN-2M-GFC	VMN-4M-GFC	VMN-8M-GFC
Description	2 Way Manifold Valve	4 Way Manifold Valve	8 Way Manifold Valve
Outlets Ports - Female	2 x 3/8 "NPT	4 x 3/8 " NPT	1 X 3/8 "NPT
Inlet Port- Female	1 X 3/8 "NPT	1 X 3/8 "NPT	1 X 3/8 "NPT
Weight	7.45kg	11.25kg	17.00 kg
Includes	Frame lifting handle	Frame lifting handle	Frame lifting handle
	1 x manifold	1 x manifold	1 x manifold
	2 x needle valves	4 x needle valves	8 x needle valves
	2 x PG-63 pressure gauges	4 x PG-63 pressure gauges	8 x PG-63 pressure gauges
	3 x CR-6 hydraulic couplings	5 x CR-6 hydraulic couplings	9 x CR 6 hydraulic couplings

### HC – High Pressure Hydraulic Hoses



- Provide a vital, high-quality, safe connection for your hydraulic equipment
- Supplied complete with an ergonomically designed protective strain reliever at both ends
- Suitable for working pressures up to 700 Bar
- 4:1 Factor of safety

HPS Model No.	Bore Size	Lengths	End Types
HPS-0603B	1/4" (6.6mm)	3 metres	3/8"-NPT - Male thread both ends
HPS-0606B	1/4" (6.6mm)	6 metres	3/8"-NPT - Male thread both ends
HPS-0610B	1/4" (6.6mm)	10 metres	3/8"-NPT - Male thread both ends
HPS-0615B	1/4" (6.6mm)	15 metres	3/8"-NPT - Male thread both ends





# 45

## RIGGING

- 46 Modulift Spreader Beams
- 53 Modulift Spreader Frames
- 54 Multi-Lug Lifting Beams
- 55 Bow Shackles
- 58 Digital Load Indicators
- 59 Polyester Round Slings
- 60 Woven Wire Rope Slings
- 61 Concrete Lifting Clutches & Thimbles
- 62 Equalising Triangles
- 63 Sheave Blocks



Unrivalled Lifting  
Precision

# Modulift Spreader Beams

The Modulift range of spreader beam assemblies offers a wide range of spans, configurations and capacities to suit your wide and varied lifting needs. Our sizes range from 24t to 1000t with spans available from 0.5m to over 30m.

## Selecting your beam

- Determine the rigging plan and type of beam to be used
- Select span
- Select capacity
- Determine ISA (included sling angle) and consider any headroom restrictions
- Call us with all of this information and we will provide a detailed specification and quotation

### Modulift Standard Range



### Modulift Heavy Range



### Modulift CMOD Range



The CMOD is a modular frame utilising corner units which are compatible with existing spreader beam struts and is modular in length and width. Every CMOD spreader frame consists of 4 x corner units, with intermediate struts that can be bolted into the assembly to achieve different spans.

Even the largest CMOD can be easily transported as the frame is broken down into modular parts, saving the cost of specialist transportation.

# Modulift Spreader Beams

## Rigging Options

- For extremely low headroom applications Modulift can design and fabricate a bespoke lifting frame to suit your exact requirements
- Our technical team are available to provide recommendations on your lift plan. Send us details of your lift including weight, lifting points and position, height restrictions, load type, centre of gravity (COG) position, crane type and lifting environment

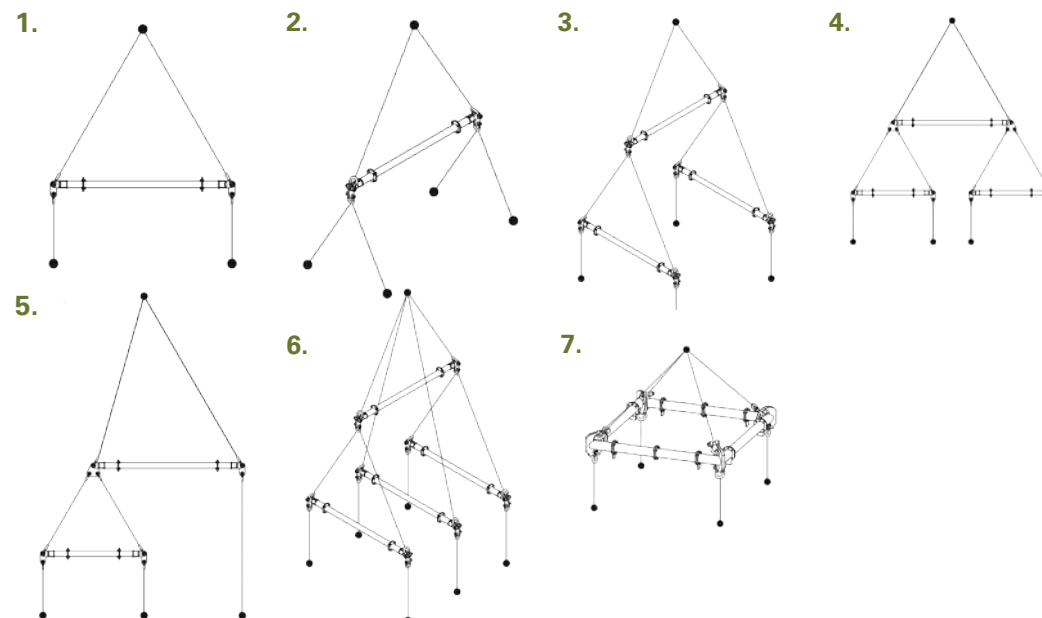

## Your Guide to Some of the Configurations Available to You

- 1. Simple Single Beam 2 Point Lift**  
A single Spreader Beam is the simplest configuration and is suitable for 2 point lifts. The Spreader Beam absorbs the compression forces to protect the load being lifted.  
Further cascading layers are available to increase the number of lifting points.
- 2. Single Beam 4 Point Lift**  
This configuration again uses a single beam where the load being lifted has four individual lifting points.
- 3. 1-Over-2 Rig**  
We use this configuration when vertical slings are essential for 4 point lifts. By varying the sling lengths, we can also take into account an offset centre of gravity.
- 4. 1-Over-2 Inline Rig**  
Ideal for those lifts where the span is long and potential bending of the load is a problem.
- 5. 1-Over-1**  
Where there are an uneven number of points to lift from, a 1 over 1 system can be used to lift the load whilst still providing a balanced rig.
- 6. Various Multi Spreader Beam Rigs**  
With our expert help we can address most lifting issues using a combination of our products to fit the application and the circumstances.
- 7. CMOD Spreader Frame**  
The CMOD spreader frame uses corner units to connect existing Modulift struts into a 4 point modular spreader frame. This uses less headroom than a 1 over 2 rig.



## Modulift Spreader Beams

### MOD 24 Spreader Beams

- Rated at 24t WLL at 5m span (30° STV)
- 'Included Sling Angle',  $\theta$ , 90° or less
- End Units and Drop Links are rated at 12t WLL each

Please refer to the table below for load ratings at alternative sling to vertical (ISA) angles and beam lengths.

Span (m)	MOD 24					
	Included Sling Angle (ISA) $\theta$					
	90°		60°		40°	
	SWL (t)	Min. Top Sling Length (m)	SWL (t)	Min. Top Sling Length (m)	SWL (t)	Min. Top Sling Length (m)
1.0	24	0.6	24	0.9	24	1.3
1.5	24	0.9	24	1.4	24	2.1
2.0	24	1.3	24	1.9	24	2.8
2.5	24	1.7	24	2.4	24	3.5
3.0	24	2.0	24	2.9	24	4.3
3.5	24	2.4	24	3.4	24	5.0
4.0	23	2.7	24	3.9	24	5.7
4.5	19	3.1	24	4.4	24	6.5
5.0	16	3.4	24	4.9	24	7.2
5.5	13	3.8	23	5.4	24	7.9
6.0	11	4.1	19	5.9	24	8.7
6.5	9	4.5	16	6.4	24	9.4
7.0	8	4.8	14	6.9	22	10.1
7.5	6	5.2	12	7.4	19	10.8
8.0	6	5.5	11	7.9	16	11.6

MOD 24		
Model	Description	Weight Item (kg)
P1	End Unit	17
P2	Drop Link	5
P3	2.0m Strut	41
P4	1.0m Strut	24
P5	0.5m Strut	16
P6	17t Safety Shackle	8
P7	12t Safety Shackle	5
P8	M20 x 50, Grade 8.8 HT Bolts, Nuts & Washers	

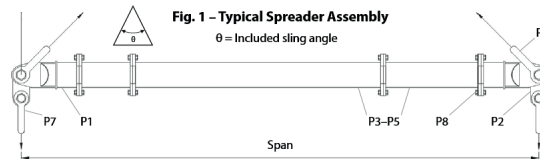

## Modulift Spreader Beams

### MOD 50 Spreader Beams

- Rated at 50t SWL at 8m span (60° ISA)
- 'Included Sling' angle,  $\theta$ , 90° or less
- End Units and Drop Links are rated at 25t SWL each

Please refer to the table below for load ratings at alternative sling to vertical (ISA) angles and beam lengths.

Span (m)	MOD 50					
	Included Sling Angle (ISA) $\theta$					
	90°		60°		40°	
	SWL (t)	Min. Top Sling Length (m)	SWL (t)	Min. Top Sling Length (m)	SWL (t)	Min. Top Sling Length (m)
1.0	50	0.5	50	50	50	1.3
1.5	50	0.9	50	50	50	2.0
2.0	50	1.2	50	50	50	2.7
2.5	50	1.6	50	50	50	3.5
3.0	50	1.9	50	50	50	4.2
3.5	50	2.3	50	50	50	4.9
4.0	50	2.7	50	50	50	5.7
4.5	50	3.0	50	50	50	6.4
5.0	50	3.4	50	50	50	7.1
5.5	50	3.7	50	50	50	7.9
6.0	50	4.1	50	50	50	8.6
6.5	44	4.4	50	50	50	9.3
7.0	39	4.8	50	50	50	10.1
7.5	34	5.1	50	50	50	10.8
8.0	30	5.5	50	50	50	11.5
8.5	26	5.8	46	46	50	12.3
9.0	24	6.2	42	42	50	13.0
9.5	21	6.5	37	37	50	13.7
10.0	19	6.9	34	34	50	14.4
11.0	15	7.6	26	26	43	15.9
12.0	12	8.3	22	22	35	17.4
13.0	10	9.0	18	18	28	18.8

MOD 50		
Model	Description	Weight Item (kg)
P1	End Unit	38
P2	Drop Link	11
P3	4.0m Strut	140
P4	2.0m Strut	82
P5	1.0m Strut	53
P6	0.5m Strut	38
P7	35t Safety Shackle	20
P8	25t Safety Shackle	14
P9	M20 x 65, Grade 8.8, HT Bolts, Nuts & Washers	

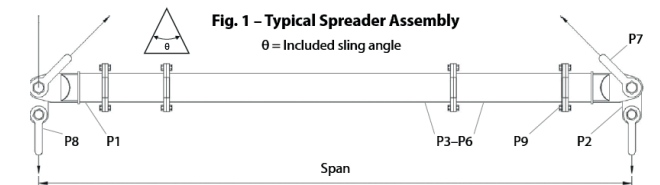



## Modulift Spreader Beams

### MOD 70 Spreader Beams

- Rated at 70t SWL at 10.5m span (60° ISA)
- 'Included Sling' angle,  $\theta$ , 90° or less
- End Units and Drop Links are rated at 35t SWL each

Please refer to the table below for load ratings at alternative sling to vertical (ISA) angles and beam lengths.

Span (m)	MOD 70					
	Included Sling Angle (ISA)					
	90°		60°		40°	
	SWL (t)	Min. Top Sling Length (m)	SWL (t)	Min. Top Sling Length (m)	SWL (t)	Min. Top Sling Length (m)
1.0	70	0.5	70	0.8	70	1.2
1.5	70	0.8	70	1.3	70	2.0
2.0	70	1.2	70	1.8	70	2.7
2.5	70	1.5	70	2.3	70	3.4
3.0	70	1.9	70	2.8	70	4.1
3.5	70	2.2	70	3.3	70	4.9
4.0	70	2.6	70	3.8	70	5.6
4.5	70	2.9	70	4.3	70	6.3
5.0	70	3.3	70	4.8	70	7.1
5.5	70	3.6	70	5.3	70	7.8
6.0	70	4.0	70	5.8	70	8.5
6.5	70	4.4	70	6.3	70	9.3
7.0	70	4.7	70	6.8	70	10.0
7.5	70	5.1	70	7.3	70	10.7
8.0	68	5.4	70	7.8	70	11.5
8.5	61	5.8	70	8.3	70	12.2
9.0	55	6.1	70	8.8	70	12.9
9.5	49	6.5	70	9.3	70	13.6
10.0	44	6.8	70	9.8	70	14.4
10.5	40	7.2	70	10.3	70	15.1
11.0	36	7.5	64	10.8	70	15.8
11.5	32	7.9	57	11.3	70	16.6
12.0	29	8.2	49	11.8	70	17.3
12.5	26	8.6	47	12.3	70	18.0
13.0	24	9.0	43	12.8	69	18.8
13.5	22	9.3	39	13.3	63	19.5
14.0	20	9.7	36	13.8	57	20.2

MOD 70		
Model	Description	Weight item (kg)
P1	End Unit	56
P2	Drop Link	17
P3	4.0m Strut	240
P4	2.0m Strut	136
P5	1.0m Strut	85
P6	0.5m Strut	61
P7	55t Safety Shackle	40
P8	35t Safety Shackle	20
P9	M20 x 65, Grade 8.8 HT Bolts, Nuts & Washers	

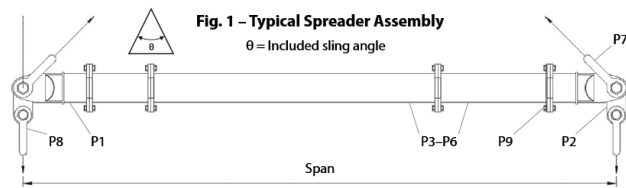

## Modulift Spreader Beams

### MOD 110H Spreader Beams

- Rated at 170t SWL at 11.5m span (60° ISA)
- 'Included Sling' angle,  $\theta$ , 45° or less
- End Units and Drop Links are rated at 85t SWL each

Please refer to the table below for load ratings at alternative sling to vertical (ISA) angles and beam lengths.

Span (m)	MOD 110H					
	Included Sling Angle (ISA)					
	90°		60°		40°	
	SWL (t)	Min. Top Sling Length (m)	SWL (t)	Min. Top Sling Length (m)	SWL (t)	Min. Top Sling Length (m)
2.0	167	1.0	170	1.6	170	2.5
2.5	167	1.4	170	2.1	170	3.3
3.0	167	1.7	170	2.6	170	4.0
3.5	167	2.1	170	3.1	170	4.7
4.0	167	2.4	170	3.6	170	5.5
4.5	167	2.8	170	4.1	170	6.2
5.0	167	3.1	170	4.6	170	6.9
5.5	167	3.5	170	5.1	170	7.6
6.0	167	3.8	170	5.6	170	8.4
6.5	167	4.2	170	6.1	170	9.1
7.0	167	4.6	170	6.6	170	9.8
7.5	167	4.9	170	7.1	170	10.6
8.0	167	5.3	170	7.6	170	11.3
8.5	158	5.6	170	8.1	170	12.0
9.0	146	6.0	170	8.6	170	12.8
9.5	134	6.3	170	9.1	170	13.5
10.0	126	6.7	170	9.6	170	14.2
10.5	116	7.0	170	10.1	170	15.0
11.0	107	7.4	170	10.6	170	15.7
11.5	98	7.7	170	11.1	170	16.4
12.0	91	8.1	160	11.6	170	17.1
12.5	84	8.4	147	12.1	170	17.9
13.0	78	8.8	137	12.6	170	18.6
13.5	72	9.1	126	13.1	170	19.3
14.0	67	9.5	117	13.6	170	20.1
14.5	61	9.9	108	14.1	170	20.8
15.0	57	10.2	100	14.6	159	21.5
15.5	52	10.6	92	15.1	147	22.3
16.0	48	10.9	85	15.6	137	23.0
16.5	44	11.3	79	16.1	126	23.7
17.0	41	11.6	73	16.6	117	24.5
17.5	38	12.0	67	17.1	108	25.2
18.0	35	12.3	60	17.6	101	25.9

MOD 110H		
Model	Description	Weight item (kg)
P1	End Unit	178
P2	Drop Link	55
P3	4.0m Strut	367
P4	2.0m Strut	212
P5	1.0m Strut	134
P6	0.5m Strut	96
P7	120t Safety Shackle	110
P8	85t Safety Shackle	62
P9	M20 x 65, Grade 8.8 HT Bolts, Nuts & Washers	

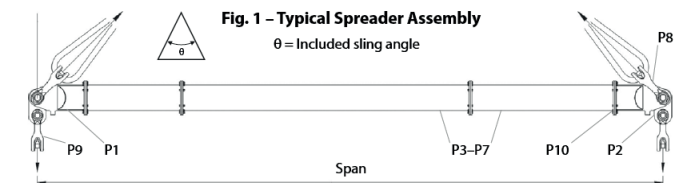



## ModuLift Spreader Beams

### MOD250/250 Spreader Beams

- Rated at 250t SWL at 14m span (60° ISA)
- 'Included Sling' angle,  $\theta$ , 90° or less
- End Units and Drop Links are rated at 125t SWL each

Please refer to the table below for load ratings at alternative sling to vertical (ISA) angles and beam lengths.

Span (m)	MOD 250/250					
	Included Sling Angle (ISA)					
	90°		60°		40°	
	SWL (t)	Min. Top Sling Length (m)	SWL (t)	Min. Top Sling Length (m)	SWL (t)	Min. Top Sling Length (m)
2	250	0.9	250	1.5	250	2.4
3	250	1.6	250	2.5	250	3.9
4	250	2.3	250	3.5	250	5.4
5	250	3.1	250	4.5	250	6.8
6	250	3.8	250	5.5	250	8.3
7	250	4.5	250	6.5	250	9.7
8	250	5.2	250	7.5	250	11.2
9	250	5.9	250	8.5	250	12.7
10	250	6.6	250	9.5	250	14.1
11	234	7.3	250	10.5	250	15.6
12	204	8.0	250	11.5	250	17.1
13	178	8.7	250	12.5	250	18.5
14	158	9.4	250	13.5	250	20.0
15	138	10.1	235	14.5	250	21.4
16	120	10.8	211	15.5	250	22.9
17	105	11.5	185	16.5	250	24.4
18	91	12.2	160	17.5	250	25.8
19	80	13.0	141	18.5	226	27.3
20	69	13.7	122	19.5	196	28.8
21	59	14.4	106	20.5	171	30.2

MOD 250/250		
Model	Description	Weight item (kg)
P1	End Unit WLL 125t	365
P2	Drop Link WLL 125t	90
P3	6.0m Strut	860
P4	3.0m Strut	495
P5	2.0m Strut	375
P6	1.0m Strut	255
P7	0.5m Strut	192
P8	200t Wide Body Shackle	205
P9	125t Wide Body Shackle	92
P10	M24 x 80 Grade 8.8HT Bolts, Nuts & Washers	

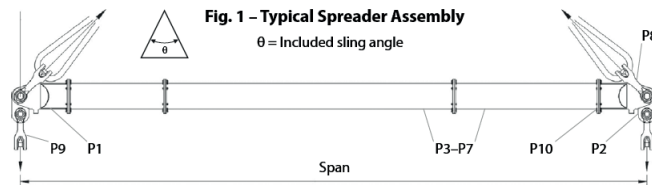

## ModuLift Spreader Frames

### CMOD Spreader Frames

- Every CMOD spreader frame consists of 4 x corner units, with intermediate struts that can be bolted into the assembly to achieve different spans
- Even the largest CMOD can be easily transported as the frame is broken down into modular parts, saving the cost of specialist transportation

Refer to load charts below and opposite for capacities at varying lengths and sling angles.

### Load Charts - CMOD 50

CMOD 50: SWL/t @ 60° ISA / 30° STV / 60° BSA

11										32	
10								41	31		
9							50	39	29		
8						50	48	37	28		
7					60	50	45	35	27		
6				60	60	50	43	33	26		
5			60	60	60	50	40	32	25		
4		60	60	60	50	49	38	31	24		
3		60	60	60	60	50	47	37	30	23	
2	60	60	60	60	60	50	45	36	29	23	
1	60	60	60	60	60	60	50	44	35	28	22
Span (m)	1	2	3	4	5	6	7	8	9	10	11

CMOD 50: SWL/t @ 90° ISA / 45° STV / 45° BSA

11											18
10										23	17
9									28	21	16
8								28	27	20	15
7							34	28	25	19	14
6						40	34	28	24	18	14
5					40	40	34	28	23	17	13
4				50	40	40	28	28	21	17	13
3			50	50	40	40	28	26	21	16	12
2		50	50	50	40	34	28	25	20	16	12
1	50	50	50	50	40	34	28	25	20	15	12
Span (m)	1	2	3	4	5	6	7	8	9	10	11

CMOD 50		
Model	Description	Weight item (kg)
P1	Corner Unit (0.5m)	90
P2	4.0m Strut	140
P3	2.0m Strut	82
P4	1.0m Strut	53
P5	0.5m Strut	38
P6	35t Shackle	20
P7	25t Shackle	14
P8	M20 X 65, 8.8 Bolts, Nuts & Washers	

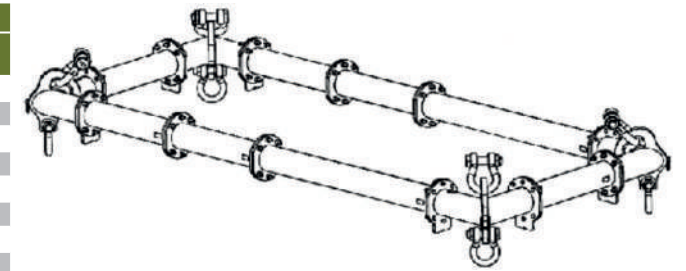

## Multi-Lug Lifting Beams

### M30T Models

- Versatile - can be used as a lifting beam, semi-spreader or for tandem lifts with zero derating of a single beam
- Flexibility - can be bolted together for longer lengths with de-rating
- Australian designed and manufactured

Model	Capacity (t)	Overall Length (m)	Weight of Beam (kg)
M30T-3	30	3	1,450
M30T-6	30	6	2,600

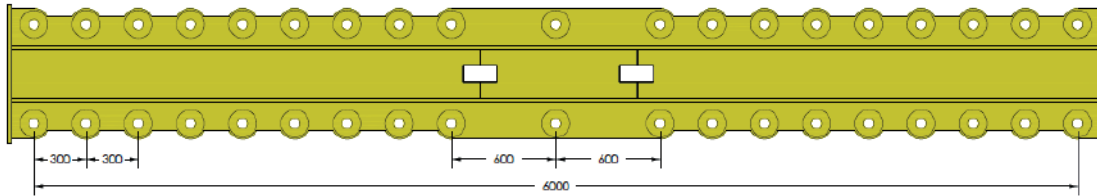
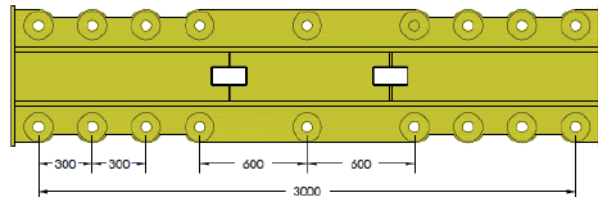

## Offset Lifting Beam

### O5T Model

- Versatile - can achieve a maximum offset of 3m and maximum capacity of 5.3t
- Can be used with 7m slings to reduce beam incline when under zero load.
- Australian designed and manufactured

Offset (m)	Minimum Headroom Required (m)	Max. Capacity (kg)	Weight of Beam (kg)
2.0	4.3	5,300	
2.5	4.3	2,990	3,465
3.0	4.3	2,515	

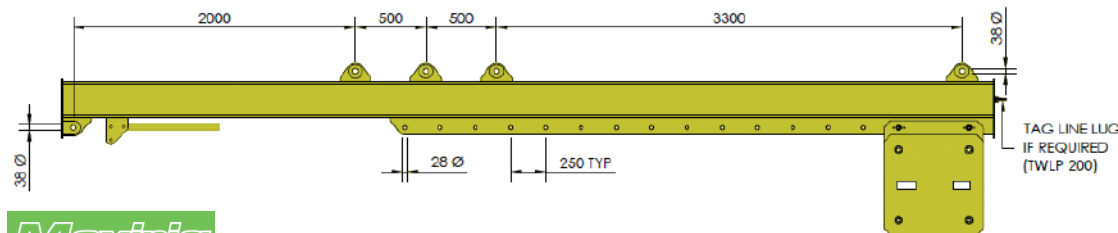

Maxirig

## Bow Shackles

### Standard Green Pin Shackles G-4161 & G-4163



- Body and pin high tensile steel, Grade 6, quenched and tempered
- Screw pin and Safety pin options
- Safety Factor: MBL equals 6 x WLL
- Hot dipped galvanised
- Temp -40°C to 200°C
- EC declaration of conformity. (Upon request basic raw material cert, manufacturer test cert, inspection cert & DNV cert)

Model	Working Load Limit (t)	Dia. Body	Dia. Pin	Dia. Eye	Width Inside	Length Inside	Width Bow	Length Overall	Length Bolt	Width	Weight Each (kg)
		a (mm)	b (mm)	c (mm)	e (mm)	f (mm)	g (mm)	h (mm)	i (mm)	j (mm)	
Screw	8.5	25	28	59	43	95	68	164	150	118	2.58
Safety	9.5	28	32	67	47	108	75	186	166	131	3.66
Screw	12	32	35	73	51	115	83	201	184	147	4.91
Safety	13.5	35	38	79	57	133	92	227	197	162	6.54
Screw	17	38	42	88	60	146	99	249	202	175	8.19
Safety	25	45	50	104	74	178	126	300	243	216	14
Screw	35	50	57	112	83	197	138	332	269	238	18.8
Safety	42.5	57	65	132	95	222	160	378	301	274	28.3
Screw	55	65	70	145	105	260	180	433	329	310	39.6
Safety	85	75	83	167	127	330	190	530	381	340	62





## Heavy-Duty Bow Shackles

### High Load Capacity Bow Shackles P-6036

- Body and pin high tensile steel, Grade 8, quenched and tempered
- Safety Factor: MBL equals 5 x WLL
- EC declaration of conformity
- Plus 5% forging tolerance on inside width and length

Working Load Limit (t)	Dia. Body	Dia. Pin	Dia. Eye	Width Inside	Length Inside	Width Bow	Length Overall	Length Bolt	Width	Weight Each (kg)
	a (mm)	b (mm)	c (mm)	e (mm)	f (mm)	g (mm)	h (mm)	i (mm)	j (mm)	
120	95	95	204	147	400	238	644	453	428	114
150	105	108	235	169	410	275	686	496	485	155
200	120	130	270	179	513	290	833	564	530	235
250	130	140	284	205	554	305	896	614	565	295

Higher capacities available upon request



## Bow Shackles

### Wide Body Sling Bow Shackles P-6033

- Bow and pin alloy steel, grade 8, quenched and tempered
- Safety Factor: MBL equals 5 x WLL
- Temp -20°C to 200°C
- Wide body profile to protect slings

Working Load Limit (t)	Dia. Body	Dia. Pin	Dia. Eye	Width Inside	Length Inside	Width Bow	Length Overall	Length Bolt	Width	Weight Each (kg)
	a (mm)	b (mm)	c (mm)	e (mm)	f (mm)	g (mm)	h (mm)	i (mm)	j (mm)	
75	68	70	126	110	290	185	473	317	331	45
125	85	80	156	137	366	220	583	413	390	92
150	94	95	181	147	391	253	648	445	449	140
200	110	105	201	158	481	280	759	480	500	205
250	126	120	229	179	542	300	860	535	552	264

Higher capacities available upon request

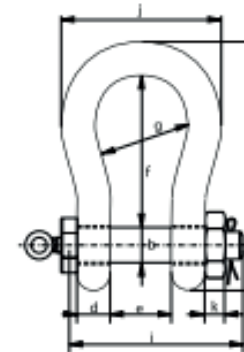
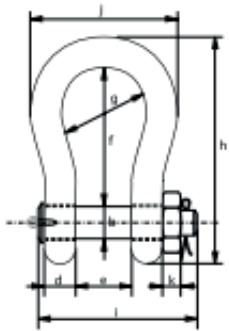



## Digital Load Indicators

### Aluminium Tension Load Cell

- High strength aircraft grade aluminium
- Safety design features
- IP67 rated load cell
- Portable & Wireless kits available

Model	Range (t)	L (mm)	W (mm)	D (mm)	S (mm)	Ø (mm)	Cell (kg)
103T-4.75	4.75	262	96	28.5	186	24	2
103T-6.5	6.5	278	100	33.8	194.7	27.5	2
103T-12	12	320	124	47.5	220	38	4
103T-17	17	328	127	56	220	44.3	5
103T-25	25	370	140	69	230	55.2	8
103T-35	35	425	146	78	260	62	10
103T-55	55	490	179	95	292	75.6	18
103T-85	85	580	210	110	340	90	30
103T-120	120	620	255	130	340	102.5	46
103T-150	150	685	250	148	380	112	55
103T- >150							On Request

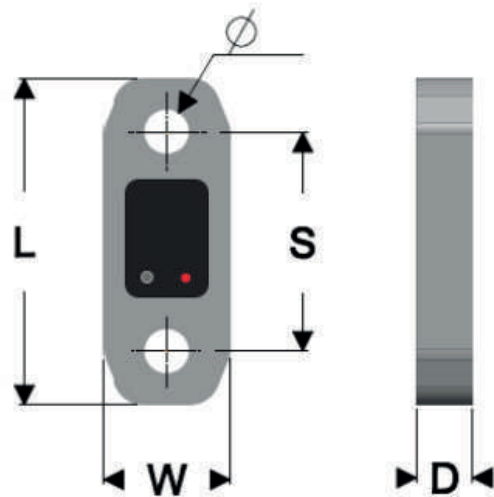

## Polyester Round Slings

### Roundslings MP Series

- Heavy duty sleeve with WLL data woven into sleeve
- Thicker sleeve means better protection of internal fibres
- Raised ribs on sleeve improves gliding characteristics when choking and improves cut and abrasion resistance
- High strength to weight ratio

Code	Colour	Rated Capacity (kg)			Minimum Length (m)	Approximate Measurements			Weight Per Metre (kg)
		Vertically	Choker	Basket		Thickness Under Load (mm)	Width Under Load (mm)	Minimum Load Edge Radius (mm)	
MP10000	Orange	10,000	8,000	20,000	3	19	90	57	2.2
MP20000	Orange	20,000	16,000	40,000	3	23	135	69	4.4
MP40000	Orange	40,000	32,000	80,000	3	37	190	111	10.0
MP60000	Orange	60,000	48,000	120,000	3	75	220	225	14.8
MP125000	Orange	125,000	100,000	250,000	4	120	325	325	33.8

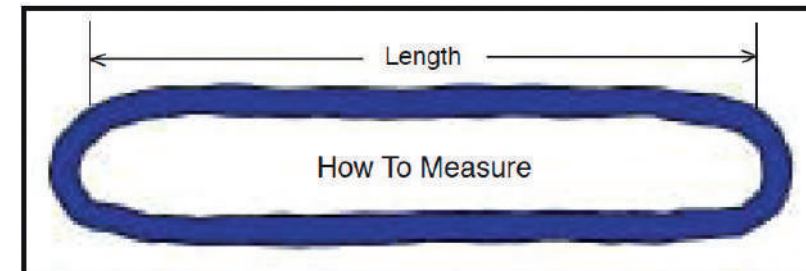



## Woven Wire Rope Slings

### Superflex Series

Superflex Single Slings are used for general lifting purposes where a flexible steel sling is needed. All slings are fitted with aluminium alloy ferrules.



## Flat Woven Wire Rope Slings

### 1-C Series

Lapped eye with ferrules both ends. Made from machine woven flat cable. All slings are fitted with aluminium alloy ferrules.

Cable Size/ Number	Minimum Breaking Force (kN)	Cable Nominal Diameter (mm)	Rated Capacity (kg)				Minimum Length (m)	WLL for Various Included Sling Angles (ISA) of 2, 3 and 4 Leg Slings			
			Vertically	Cradle Lift @ <30	Choked on Round Load	Choked on Rectangu- lar Load with Edge Radius >1.0 D		<30	60	90	120
Five-5	270	22	5.2	10.2	3.9	2.6	3	10.2	9.0	7.3	5.2
Six-5	345	26	6.7	13.1	5.0	3.4	3	13.1	11.6	9.4	6.7
Eight-0	530	32	10.3	20.2	7.7	5.2	3	20.2	17.8	14.5	10.3
Ten-0	790	40	15.3	30.0	11.5	7.7	3	30.0	26.5	21.6	15.3
Twelve-0	1110	48	21.6	42.1	16.1	10.8	3	42.1	37.2	30.3	21.5
Fourteen	1460	56	28.3	55.5	21.2	14.2	3	55.5	49.0	39.9	28.3
Seventeen	2168	68	42.1	82.5	31.6	21.1	3	82.5	72.8	59.4	42.1
Twenty-0	3015	80	58.5	114.7	43.9	29.3	3	114.7	101.2	82.5	58.5
Twenty Four-0	4340	96	84.3	165.2	63.2	42.1	3	165.2	145.8	118.9	84.3

Size	Woven Flat Cable					Minimum Length (m)	Sling WLL (tonnes)			
	24 Ply Warp - Fine Cords - 2 Ply Weft - Fine Cords						Cradle Lift - Included Angle at the Hook			Proof Load
	Flat Cable Thickness (mm)	Generic Cord Size (mm)	Weight (kg/m)	Woven Jack- et Nominal Dia	WLL in Single Fall (kN)		<30	60	120	
50	5	2.0	0.4	32	10.2	3	1.9	1.7	1.0	20.4
64	7	2.5	0.6	38	16.0	3	3.0	2.7	1.6	32.0
76	8	3.0	1.0	52	23.8	3	4.5	4.0	2.3	47.6
88	10	3.5	1.3	62	31.6	3	6.0	5.3	3.1	63.2
100	11	4.0	1.6	70	42.5	3	8.1	7.1	4.1	85.0
112	12	4.5	2.1	76	53.4	3	10	9.0	5.2	107
125	14	5.0	2.7	102	71.4	3	13	12	7.0	143
160	17	6.5	4.3	120	114	3	21	19	11	228
200	20	8.0	6.9	150	170	3	32	28	17	340
250	25	10.0	10.3	170	255	3	48	43	25	510





## Equalising Triangles

### EQP Series

- Improved load distribution
- Increased safety
- Versatility
- Cost effective

Model	Capacity (t)	Weight (kg)	Shackles
EQP1010	10	15	(1) Lifting Lug - 12t Grade S Bow Shackle (2) Load Lug - 6.5t Grade S Bow Shackle
EQP1025	25	25	(1) Lifting Lug - 25t Grade S Bow Shackle (2) Load Lug - 13.5t Grade S Bow Shackle
EQP1035	35	50	(1) Lifting Lug - 35t Grade S Bow Shackle (2) Load Lug - 25t Grade S Bow Shackle
EQP1055	55	90	(1) Lifting Lug - 55t Grade S Bow Shackle (2) Load Lug - 35t Grade S Bow Shackle
EQP1085	85	130	(1) Lifting Lug - 85t Grade S Bow Shackle (2) Load Lug - 55t Grade S Bow Shackle
EQP1200	120	190	(1) Lifting Lug - 120t Grade S Bow Shackle (2) Load Lug - 85t Grade S Bow Shackle
EQP1500	150	300	(1) Lifting Lug - 150t Grade S Bow Shackle (2) Load Lug - 85t Grade S Bow Shackle

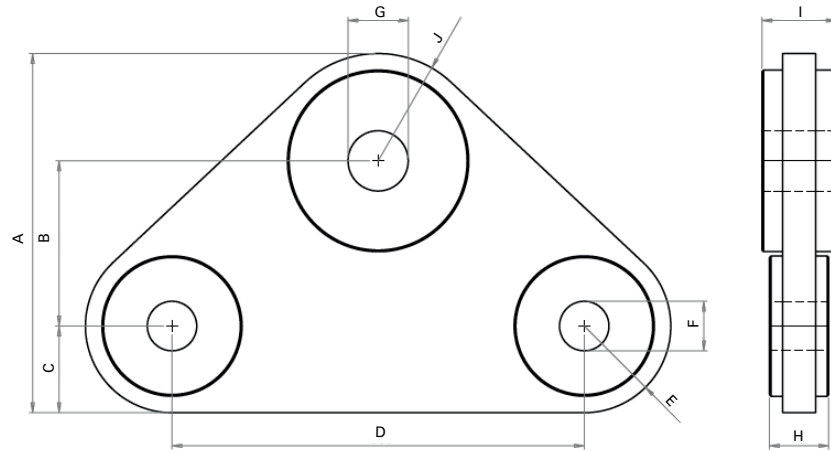

Model	A (mm)	B (mm)	C (mm)	D (mm)	E (mm)	F Ø (mm)	G Ø (mm)	H (mm)	I (mm)	J (mm)
EQP1010	210	105	45	300	R45	28	38	32	48	R60
EQP1025	280	130	60	350	R65	41	54	45	65	R85
EQP1035	340	150	70	450	R85	54	60	64	72	R105
EQP1055	435	200	105	500	R105	60	73	72	90	R130
EQP1085	-	225	130	500	R130	73	90	90	104	R150
EQP1200	-	310	150	600	R150	90	100	104	104	R170
EQP1500	-	250	-	900	R160	88	115	92	124	R200



## Sheave Blocks

### Light Snatch Block with Shackle

- Snatch blocks are supplied with bronze brushings and grease fittings for ease of use and extended shelf life
- Manufactured with the highest tensile steel for improved performance
- Sheave sizes from 76mm Dia. (8-10mm rope) to 203mm (25-29mm rope)
- Available in capacities 2 - 20 tonnes

Model	Sheave Dia. (mm)	Bearing Type	Wire Rope Size (mm)	Working Load Limit (t)	B (mm)	E (mm)	F (mm)	G (mm)	L (mm)	R (mm)	T (mm)	Weight (kg)
150102	76	Bronze	8-10	2	19	64	11	75	228	217	11	2
150104	114	Bronze	10-13	4	34	82	19	108	355	336	19	6
150108	152	Bronze	16-19	8	64	112	32	152	483	451	32	13
150108-08	203	Bronze	16-19	8	64	112	32	220	557	525	32	20
150112	152	Bronze	19-22	12	80	141	44	166	540	496	44	24
150115	254	Bronze	19-22	15	80	141	44	280	714	670	44	41
150120	203	Bronze	25-29	20	93	146	55	216	671	616	51	42

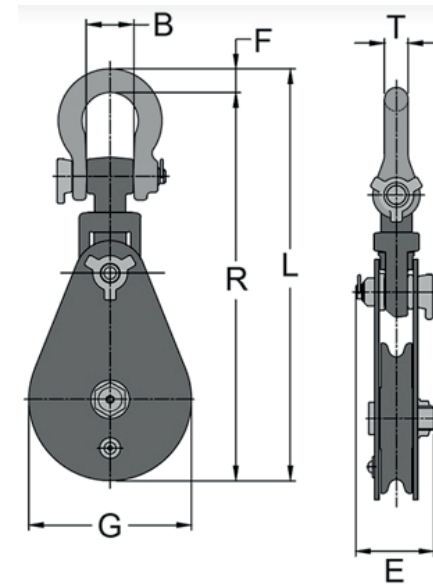



65

# MATERIAL HANDLING

- 66 Material Lifts & Accessories
- 67 Material Lifts
- 68 Gas Hoists & Crane Bins
- 69 Goods Cages



Unrivalled Lifting  
Precision



## Material Lifts & Accessories

### Genie Superlift Advantage

Choose base, mast height, winch speed & load handling attachments to configure the exact material lift for your work site.

- Heavy-duty design
- Patented telescoping mast system with mast brake
- Rolls easily through single door in upright position
- Quick set up requires no tools
- Compact design, legs fold up for easy storage
- Roller wheels allow easy transport in stowed position
- Easy to load and unload on or off a vehicle for transport

Model	SLA-10	SLA-15	SLA-20	SLA-25
Measurements	Metric	Metric	Metric	Metric
Working Height: Standard Forks- Down	2.97m	4.46m	5.94m	7.42m
Working Height: Standard Forks- Up	3.49m	4.98m	6.46m	7.94m
Working Height: Adjustable Forks- Down	2.97m	4.46m	5.94m	7.42m
Working Height: Adjustable Forks- Up	3.49m	4.98m	6.46m	7.94m
Working Height: Flat Forks	2.97m	4.46m	-	-
Working Height: Boom	3.28m	4.76m	6.25m	7.42m
Working Height: Load Platform- Forks Down	2.97m	4.46m	5.94m	7.42m
Working Height: Load Platform- Forks Up	3.49m	4.98m	6.46m	7.94m
Height - Stowed	2.0m	2.0m	2.0m	2.0m
Length - Stowed	74cm	74cm	74cm	79cm
Length - Operating	1.51m	1.88m	2.08m	2.08m
Width - Stowed	80cm	80cm	80cm	80cm
Width - With Stabilisers Lowered	1.85m	1.85m	1.85m	1.85m
Width - Straddle Base Minimum	80cm	80cm	-	-
Width - Straddle Base Maximum	1.47m	1.47m	-	-
Width - Straddle Base Maximum Inside	1.27m	1.27m	-	-
Ground Clearance	5cm	5cm	5cm	5cm
Load Height Minimum	15cm	15cm	15cm	15cm
Front Casters	10cm	10cm	10cm	10cm
Rear Casters	13cm	13cm	13cm	13cm
Load Capacity 46cm (18in) Load Centre	454kg	363kg	363kg	295kg
Load Capacity 61cm (24in) Load Centre	454kg	363kg	272kg	204kg
Load Capacity 107cm (42in) Load Centre	181kg	227kg	159kg	113kg
Average Cranks Standard Winch	27.8 cranks/m	27.8 cranks/m	27.8 cranks/m	27.8 cranks/m
Weight Standard	118kg	151kg	184kg	204kg
Weight Straddle Base	137kg	163kg	-	-



### Standard Forks (Down)

A variety of general loads. Get an additional 21in (53cm) of lift by turning over and re-pinning the forks.



## Material Lifts

### Genie GL Lift - Counterweight Base

Three base models and many accessories to choose from.

- The GL-8 can lift up to 181kg to a height of 3.0m, while the GL-12 can lift up to 159kg to a height of 4.2m
- The Genie Lift is well suited for shipping/receiving, lifting heavy material to or from shelves, installing and repairing HVAC components, lifting and moving automotive parts, and other manufacturing applications
- Compact, versatile and easily transported

Model	GL-8	GL-10	GL-12
A Height - Stowed (mm)	1720	2000	2310
Maximum Forks Down (mm)	2500	3010	3660
Maximum Forks Up (mm)	3060	3560	4200
Minimum Forks Down (mm)	90	50	50
Length - Operating (mm)	720	720	-
Width - Stowed (mm)	730	730	-
Maximum (mm)	1110	1110	-
Maximum Inside (mm)	910	910	-
Load Height Minimum (mm)	90	90	90
Ground Clearance - Centre (mm)	20	20	20
Average Cranks - Standard Winch per mm	38	38	38
Fork Length (mm)	570	570	570
Fork Width (mm)	520	520	520
Load Platform Length (mm)	580	580	580
Load Platform Width (mm)	560	560	560
Load Capacity at 300mm Load Centre (kg)	181	159	159
Boom Length (mm)	510	510	510
Boom Attachment Points (mm)	340/480	340/480	340/480
Weight - Standard Caster Options (kg)	186.0	196.0	-



## Gas Hoists

### Genie Gas Hoists

- A unique portable pneumatic lift
- Incredibly compact, easy-to-use design
- The portable telescoping pneumatic hoist offers two lifting options: 136kg to 3.8m and 113kg to 5.6m, both powered by CO<sub>2</sub> or compressed air

Model	Height		Platform Length (mm)	Width		Load Capacity (kg)	Storage Dimensions (mm)	Wheels Diameter (mm)	Recommended psi (bar)	Weight (kg)
	Stowed (mm)	Lift Height (mm)		Platform (mm)	Base (mm)					
GH-3.8	1040	3800	480	610	1.350	136	360 x 360 x 1000	200	5.86	34.0
GH-5.6	1370	560	480	610	1.350	113	360 x 360 x 1000	200	5.86	37.0



## Crane Bin

### 2t/4t/6t Material Baskets

- Heavy duty construction: 4mm floor, 3mm walls, 4mm top rails
- Safety lifting points x 4
- Forged end tipping points x 4
- Reinforced floor frame with full length forklift pads

Model	Capacity (t)	Length (mm)	Width (mm)	Height (mm)	Weight (kg)
CR-20-N	2	1910	1720	990	
CR-40-N	4	2850	1780	1310	
CR-60-N	6	3710	1780	1310	



## Goods Cage

### 2t Material Basket - With Gate

- Simple yet solid construction
- Forklift tyne pockets (140mm x 65mm)
- Australian designed and made
- The product is supplied with a proof load test certificate, MPI welding inspection report and certificate of conformance to Australian Standards (AS4991).

Model	Capacity (kg)	Length (mm)	Width (mm)	Height (mm)	Weight (kg)
GCG2201	2,000	1400	1400	1310	255

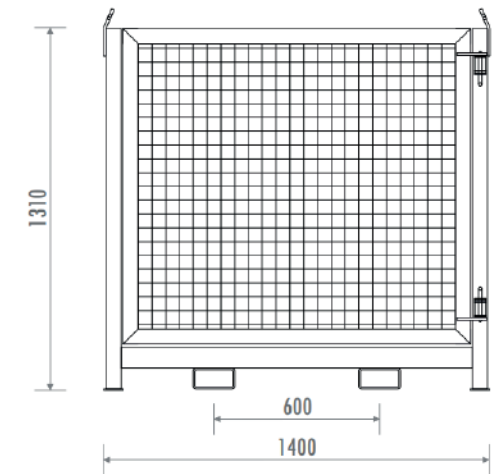



71

## SAFETY

- 72 Rescue Cages
- 73 Manbaskets
- 74 Confined Space Equipment
- 75 Fall Arrest Harness



Unrivalled Lifting  
Precision



## Rescue Cages

### Three Person

- Supplied with workcover design registration
- Heavy duty spring loaded gate
- Supplied with 4-leg chain sling to suit
- Australian designed and made

Model	Capacity (kg)	Length (mm)	Width (mm)	Height (mm)	Weight (kg)
DMC1045	3 person/450	2530	1330	2265	550



## Manbaskets

### Two Person Offset

- Supplied with workcover design registration
- Heavy duty spring loaded gate
- Supplied with 4-leg chain sling to suit
- Australian designed and made

Model	Capacity (kg)	Length (mm)	Width (mm)	Height (mm)	Weight (kg)
OMC1300	2 person/300	2012	1020	1155	700



## Manbaskets

### Single Person

- Supplied with workcover design registration
- Supplied with 4-leg chain sling to suit
- Australian designed and made

Model	Capacity (kg)	Length (mm)	Width (mm)	Height (mm)	Weight (kg)
AMC1013-R	1 person/125	600	600	2300	125



### Three Person

- Supplied with workcover design registration
- Heavy duty spring loaded gate
- Supplied with 4-leg chain sling to suit
- Australian designed and made

Model	Capacity (kg)	Length (mm)	Width (mm)	Height (mm)	Weight (kg)
CMC1035-R	3person/350	1200	1200	2300	390

## Confined Space Equipment

### Heavy Duty Tripod

Ultra lightweight, tough and with a durable alloy construction, the TRIPOD-HD is primarily to be used as personal protective equipment, to provide access or fall protection in confined space environments.

- Rectangular, fully adjustable legs
- Integrated twin pulleys and an additional auxiliary anchorage point
- Access, egress and rescue equipment



Model	Capacity	Description	Dimensions		Weight (kg)
			Height (mm)	Footprint (mm)	
TRIPOD-HD	360kg	Height Adjustable Tripod	1860-2700	2300	24kg

### SVLWB Material Winch

The SVLWB functions as a secondary back up device where there is no assistance for the descent such as a ladder. An essential piece of equipment.

- Heavy Duty Tripod Bracket - Used to connect SVLWB winches to Adjustable Tripod



Model	Description	Weight (kg)	Cable Material	Max/Min Work Load (kg)	Mechanical Advantage
SVLWB-30	30m material/personnel winch	15.5	Galvanised Steel	150/12	22:1
SVLWB-45	45m material/personnel winch	18	Galvanised Steel	140/15	22:1

### SRLR Recovery Blocks

- Integrated recovery winch function
- Steel triple action karabiner with swivel and fall indicator for harness connection
- Galvanized steel cable lifeline
- Aluminium Housing



Model	Description	Weight (kg)	Length	Lifeline	Casing	Connection
2002382- HRA 33	SRLR STU A S 30 STA-30m Fall Arrest Block	21	30	Galvanised Steel Cable	Aluminium	2002206

## Fall Arrest Harness

### ERGO iPlus 1100 Full Body Fall Arrest Harness

- Front and rear fall arrest D ring
- iWeb™ Inspection ready webbing with water and oil resistant Xtreme Guard.
- Premium padded shoulders and legs.
- Lightweight aluminium fittings and quick connect buckles.
- Fully adjustable shoulder, chest and leg straps.
- Suitable for fall arrest, roof work, ladder systems, EWP, maintenance and construction.
- Confined space entry loops and suspension trauma relief straps.



# Need a lifting solution?

Let us handle the heavy lifting.



# OUR MISSION

Since 1970...

LGH's mission is to support customers across the globe with the safest and most reliable lifting and rigging gear, through continuous investment in our people, our equipment and our IT systems.

# OUR PROMISE:

Ready when you are

At LGH, we don't just rent equipment; we provide peace of mind. Our extensive inventory is meticulously selected for its durability and reliability. This ensures that customers like you have access to the highest quality hoisting, pulling, jacking and rigging gear on the market. Meticulously maintained and ready for action, our equipment is a testament to our unwavering dedication to safety and efficiency.

Experience the LGH difference today. Contact us:



1800 407 712  
[enquiries@lgh.au](mailto:enquiries@lgh.au)



The lifting gear hire specialists you can depend on for **Range, Expertise, Simplicity & Safety.**



Enquire with our Customer Contact Centre on:

Tel: 1800 407 712 Web: [www.lgh.au](http://www.lgh.au) Email: [enquiries@lgh.au](mailto:enquiries@lgh.au)  
152 Somersby Falls Road, Somersby, NSW 2250



SCAN  
TO VISIT

